

CUSD



Community Input Meeting Notes

August 23, 2013



Facilities Master Plan Community Meeting Notes

Thank-you to all contributors, these community meetings were successful because of your participation and input!

Initial Community meetings were held at the three Jr. Highs, with an invitation to all feeder elementary schools in each of the Jr. High boundary areas. Flyers, parent memos, and weekly calls were made to all homes in the boundary areas to promote attendance. The purpose of the meetings was for input on school facilities. This document contains this input. It is extremely important that this is not seen as a list of "to-do's" at each campus, but as input to be used in conjunction with all the other data being collected. All data will be used to further discuss and analyze the most prudent way to use the Measure E funding and all other subsequent funding. Additional Community meetings will be held to discuss the analysis and prioritization. Input taken by the School District is included as reference for each site, as well as some added community input received by those who could not attend the meeting in person but sent the District their comments.



Help Define Your Kid's Space to Learn

- April 30th @ Marsh Jr. - Library**
For Marsh Jr., Little Chico Creek, Loma Vista, Parkview & Sierra View
- May 2nd @ Chico Jr. - Theater (Rm 505)**
For Chico Jr., Citrus, Chapman, Hooker Oak, Emma Wilson & Rosedale
- May 8th @ Bidwell Jr. - Multi-Purpose Rm**
For Bidwell Jr., John A. McManus, Marigold, Neal Dow & Shasta

5:30 PM - 7:30 PM

**Measure E
Community Input
Meetings**

District Facilities Master Plan



Contents

Marsh Jr. High School.....	3
Loma Vista Special Education School.....	4
Little Chico Creek Elementary School	6
Parkview Elementary School.....	8
Sierra View Elementary School	11
Citrus Elementary School.....	13
Emma Wilson Elementary School	15
Rosedale Elementary School.....	17
Chico Jr. High School	20
Hooker Oak Elementary School	23
Chapman Elementary School.....	26
Bidwell Jr. High School	27
McManus Elementary School	30
Marigold Elementary School.....	31
Shasta Elementary School.....	33
Neal Dow Elementary School.....	36
Pleasant Valley High School	39
Academy For Change (AFC) & Center for Alternative Learning (CAL).....	44
Fairview Continuation High School	44
Oakdale Independent Study	44
Inspire School of Arts and Science	48
Chico High School.....	52
APPENDIX.....	56



Marsh Jr. High School

(Facilitator: Tim and Ellen)

- There are currently 75 parent tours a year
 - On the tour they skip the Multi Purpose Room which is in a portable, but show the:
 - Admin
 - Classrooms
 - Culinary Art
 - CA
 - Gym
 - Library
- Current enrollment is 550-600 students
- Music Performance space & classroom is needed
- WIFI should be big enough to handle devices for students

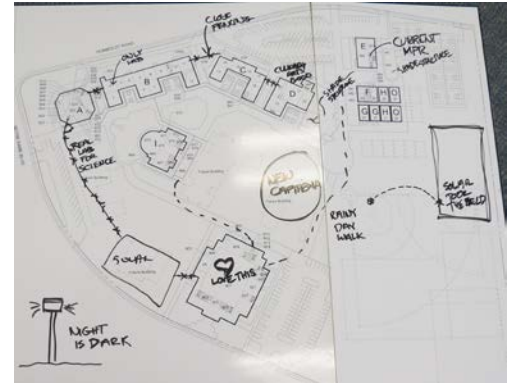

MEASURE E SCHOOL SITE SURVEY

Conducted prior to community input meeting and provided to design team

Marsh Jr. High:

Staff Recommendations	Student Input	Parent League and School Site Council Input
Update technology	Cafeteria	Update technology
Updates to buildings	Over-haul student bathroom attached to library	Updates to buildings
Fix library roof	Sinks, fans, hand dryers, everything in student bathroom	Fix library roof
Updates to fields-baseball and track	Soccer goals on fields	Create more roofed walkways
Create more roofed walkways	Towels to dry hands if they can't get hand dryers	Cafeteria
Science lab	Book drop for library	More security cameras/update existing
Cafeteria	New drinking fountains with bottle-filler or water filter	Proper security lighting
More security cameras/update existing		Fans in bathrooms
Proper security lighting		Proper graffiti free walls
Fans in bathrooms		Update water fountains/add faucets to fill water bottles
Proper graffiti free walls		Fencing around the school
New elective room		More walkways between gym and classrooms
Update water fountains/add faucets to fill water bottles		

Loma Vista Special Education School

(Facilitator: Ellen)

- All toilets have ADA-accessibility issues
- There is no meeting space for IEP's
- PA is too loud
- Need more grass for play, could add the area out front
- Sinks outside the toilet area need repair
- Need shade on playground
- Sand on playground is not accessible
- Need ADA-accessible doors
- Lots of bugs on campus
- Asbestos issues (tile, piping) throughout campus
- Need more cleanable finishes
- Playground, equipment & sand area are not accessible
- Elementary school students are small people in scale so they need small toilets and sinks, etc.
- Manzanita Ave. is less busy and may be better for drop off area



(Facilitator: Mike)

- Pickup & Drop-off traffic is very difficult on both sides of the street, but street reconfiguration could be detrimental to PVHS & LV, there is a need short term parking and drop-off
- Parking is limited as it's shared with adjacent Marigold Elementary School & other programs (what is the status of City planning on Marigold Ave.)
- Need to review program start times, there are current conflicts on start & ending times with Marigold & PV
- Need more space to support District-wide preschool & special education programs (there are District-wide staff housed on this site)
- Need water fountains at playground
- Need designated preschool & staff bathrooms
- Asbestos tile in Rm. 3 & others
- ADA issues throughout site & building
- Insufficient ventilation in bathrooms
- No large or small conference rooms available
- Site preschool program expanding so they need additional space
- Need fire alarm & PA systems fixed (repair/replace)
- Need additional classrooms based on current (FY 2013-14) and future growth
- Need additional space for preschool Special Ed classes (currently 7 classes)
- Private non-profit program could possibly relocate to another site to free up space
- Private for-profit programs taking up District program space, especially the common areas

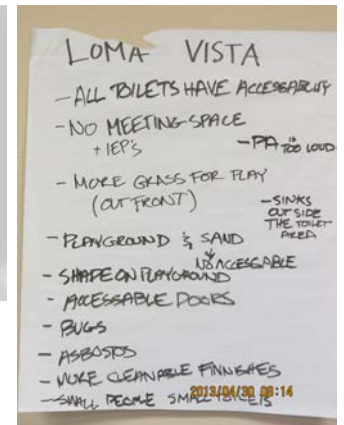

MEASURE E SCHOOL SITE SURVEY

Conducted prior to community input meeting and provided to design team

Loma Vista Elementary School:

Staff Recommendations	
Playground expansion--new equipment--recycled turf--shade	Removal of old A/C, boiler room equipment
New shed for storage of equipment on playground	Built-in storage
Specialized flooring on playground so all students have access (ADA compliant)	Covered sandbox for big playground
Change classroom door locks to inside for safety	Heated water in all sinks
Carpet, flooring, lighting throughout building	New playground boxes around equipment
iPads/touch screens updated technology for staff and students	Increase size of playground areas
New roof	Fences for exterior of school
New A/C and heating system	New landscape--lawn for playground
New dishwasher and laundry facility including commercial washer/dryer to comply with regulations for preschool setting	Shape areas for playground
Windows in bathrooms	Paint interior and exterior walls on room 2 patio area
New portable with kitchen/bathroom life skills	New carpet in room 2
New drinking fountains throughout building	Replace back door room 2
Additional office space	Replace slats in back patio area
Storage for additional materials and equipment	Kitchen equipment in room 2
3 portable classrooms	Built-in study carrels in classrooms (room 2)
Handicapped accessible entrance doors--three doors	Gross motor skills equipment
Exterior lighting	Computers--updated
Confidential storage for files, exited students	Shelves in bathrooms
Updated/upgraded staff/student restrooms	Install an updated telephone system in the school
	Remove bathtub and pipes from speech room
	Reconfigure partitions in classroom (room 2)
Parent Feedback	
Redo parking to increase the amount of parking spaces	
Redo outside play yard: level and increase size	
Redo bathrooms	
Restructure classrooms to make a 2:1 classroom/bathroom ratio	
Make a larger indoor gross motor area to teach play/sports	

Little Chico Creek Elementary School

(Facilitator: Marty)

- The A/C & heating was repaired recently
- School needs painting
- Need wiring for LCD projectors to eliminate exposed wires on floor & add interactive boards
- Wireless in areas except computer labs are hardwired
- Wireless systems district wide do not have enough bandwidth, need more bandwidth
- Hartford road will be pushed through to create more traffic
- This school is located in a housing growth area
- Rattlesnakes have been seen on campus, is there a natural deterrent? Can we incorporate some type of education or signage related to the snakes
- Older portables have aging HVAC equipment which is very loud
- Benches on site for students seating are needed
- Playground was resurfaced and painted for holistic painting
- Gopher holes in playfields, which is a common theme at many Chico school sites
- Want a track for students to run measured
- Room 7 is hot
- More playground equipment would be nice
- K-6 playground equipment could be expanded since they went from 2 kindergartens to 3
- Doors to library are hard to open
- Shade canopy for instruction would be great since this school has a large field
- Check toilet stall door locks as some need repair
- Add foam carpet at play structures
- More drinking fountains or a hydration station is needed as there are only two existing and they don't put much water out
- Ant problem at this campus
- Mold or black stuff on exterior needs to be removed
- Library has high windows with area that traps heat

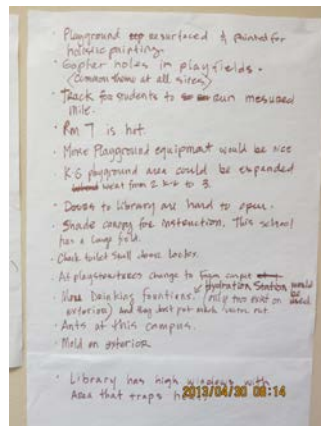
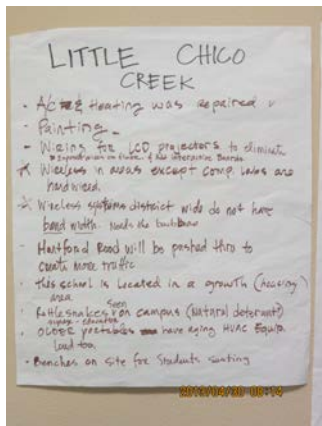

MEASURE E SCHOOL SITE SURVEY

Conducted prior to community input meeting and provided to design team

Little Chico Creek Elementary School:

Staff Recommendations	Student Input	Parent/Community Input
Repair AC/heating units for school	Better carpet	Means of keeping rattlesnakes off the playgrounds
Repair AC/heating units in portables	More benches	Key cards to get into all the classrooms
Resurface playground	Resurface ball wall	Daily code change to input into a keypad box at doors
Repair field (eliminate gopher holes, flatten surface)	Inside basketball court	Upgrade computers in classrooms
Add running track	Heaters	
Additional playground equipment	Doors on library are hard to open	
Technology upgrades	Canopy/shade structure	
Wiring for interactive boards and projectors	Locks on doors in bathrooms	
Interactive boards	Foam floor for play equipment	
Upgrade classroom hardware	More water fountains	
	Fencing to keep students away from trees	

Parkview Elementary School

(Facilitator: Haley)

- PTO is funding Track that is planned for install this summer
 - There is PE equipment going in – order in process
- Safety & security list previously provided complete
- STEM school is important to the school's identity
- Need to promote STEM education through the facilities
- The Science program needs lab tables with gas, water, etc.
 - Facility needs to be flexible, portable, facilitate groups
- Outdoor learning lab at park nearby is important strength
- Outdoor Education Center is needed
- Thinking big about the future of this program
- Board Room is desired
- Music is math, part of the teaching philosophy
- Multi Purpose Room (MPR):
 - MPR is too small, there is no space to accommodate entire student body
 - Can't bring students together to learn how to perform, public speaking, etc.
 - Stage is too small
 - Maybe add on to MPR so if could expand to house more people, but also do Physical Education in there
 - Chico H.S. has roll up garage doors going in, this similar concept would be great at Park View because of the
 - Needs to actually be multi-functional
- Science labs need to be upgraded, they need to be modern, easy to use by elementary school students. Look at Chico H.S. lab, which is a great example
- Would be great to have a gym
- Technology needs:
 - Electrical loads are often blowing breakers
 - More plugs are needed in many rooms
 - Building E is dark inside for learning environment, it needs more natural light
- Need better science labs since so much student learning is happening in that space
- Currently have a great computer lab
- Improve the spotty wifi in Building G
- Safety needs:
 - Restrooms need to be updated, specifically the tile, and other flooring
 - Drinking fountains need to be fixed, they get clogged
 - Need drinking fountains by fields to keep kids hydrated
 - MPR is safety concern because it can't fit existing population or projected growth
 - Sound System in MPR has wires that are fire hazard so it's been unplugged
 - This is a STEM school, but can't bring students together at one time, safety assemblies, etc, since there is no space to hold them or sound system for assembly reasons
 - The Cafeteria in-wall tables/benches are dangerous to operate
 - The perimeter fencing needs to filter foot traffic to office

- Between Buildings A & B there is no security
- Need: Security cameras, walkie talkies, call boxes in classrooms, panic button in office, exterior lighting site lighting
- Play field is a train wreck!! Dangerous for kids
- There is no hot water at student restrooms
- Kindergarten playground equipment is not safe
- All playground equipment needs safety improvements - the play equipment at Marigold is a great example of what is wanted
- Bike paths are dangerous for students to maneuver with vehicle traffic
- Traffic flow isn't ideal for parent drop off & pick up, needs improvement
- STEM Program needs:
 - Visual representations of curricular implementations of staff so people can clearly see that STEM is being taught, the existing garden is a great example, but other outdoor learning spaces would be great to have
 - Need to see sustainability both in the architecture and in the learning environments, for example a weather station or solar panels or other features to highlight sustainability in program and in facilities
 - Need Labs for Science!
 - Embrace STEM, celebrate it so you can show it off
 - Could be great opportunity for Chico as only STEM north of Sacrament
- Playfields need to look groomed, maintained, taken care of

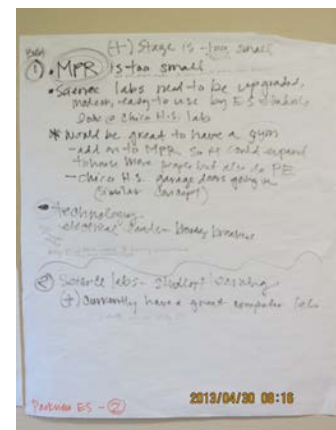
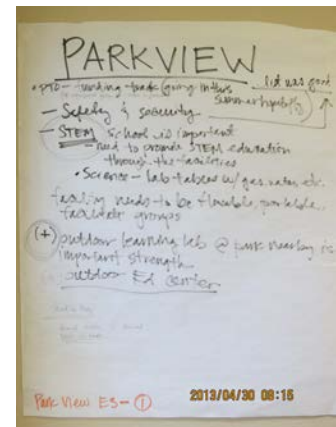

MEASURE E SCHOOL SITE SURVEY

Conducted prior to community input meeting and provided to design team

Parkview Elementary School:

Staff Recommendations	Parent Input
Electrical upgrading in Classrooms	Security Cameras
Solar Energy	Gymnasium added or expanded MPR
Security Cameras	Baseball backstops in the field
Drainage off buildings (downspouts not working well)	Field renovation: Gopher control, irrigation repair/redesign, turf re-seeding
Drainage on blacktop behind room 17	Security lighting outside campus especially in front circle area near MPR
Rebuilding of woodchip boxes	Emergency call boxes in classrooms
Interior lighting upgraded in library building	Exterior paint
Exterior lighting from MPR into parking lots	
Automatic doors for ADA accessibility	
Low flow toilets in adult bathrooms	
Hot water for student restrooms (health concern)	
Field refurbished	
Heating in women's adult restroom	
Upgraded playground structures on all playgrounds	

Sierra View Elementary School

(Facilitator: Nick)

- Technology infrastructure needs include: Replace backbone with fiber optics , this is the most needed
- Increase parking lot capacity as this is a major problem for the school and parents; there is possibly room to do this to the east of existing lot
- Re-grade the play field between the goal posts to provide good drainage and eliminate current mud holes
- Better fencing and gates to improve security system are needed
 - Reduce the number of entry points
 - Provide a way to secure gates after hours
 - Investigate possibility for a single-point-point of entry to the campus
- Provide HD security cameras with ability for face-recognition
- Need a new HVAC system
 - School is 60+ years old
 - Has it ever been upgraded?
- Additional NEW or EXPANDED facilities needs in no order of priority are as follows:
 - Kindergarten Room 22 needs an office
 - Cafeteria is too small
 - Lunches now in 3 shifts to accommodate all students
 - No way to have an all school assembly with 650 student body
 - Is it possible to expand east into existing parking lot if lot is also expanded
 - Replace the 4 existing portables with new construction
 - Parents concerned about moldy smells and only one exit (only one exit is required by code)
 - Expand the office area to include a larger staff area (Rm. 917) and work room (Rm. 923) as well as janitorial center. Do this by possibly expanding to the east (remove a big tree; which could be an issue) and enclosing the corridor to the west of Administration (which would help with the circulation security issue as well)
 - Increase the size of the very small computer room (Bldg. E) to the east, again into the existing parking area, as this lot will be expanded further east as well
 - Expand the Library to the east into the existing parking lot

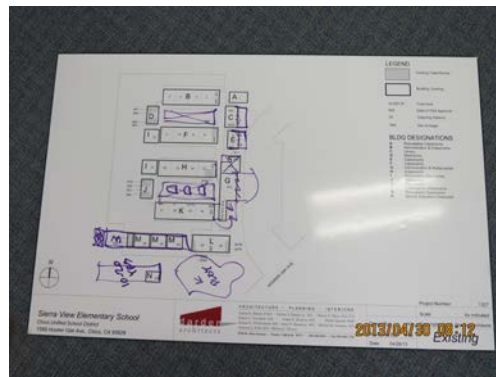

MEASURE E SCHOOL SITE SURVEY

Conducted prior to community input meeting and provided to design team

Sierra View Elementary School:

Staff Recommendations	Student Input	PTA, PAC, & SSC Input
Structural-Major	Structural-Major	Structural-Major
Enlarge parking lot	Remodel Intermediate Courtyard rooms	Enlarge parking lot (According to Parent Surveys it is a huge need)
Remodel & update adult restrooms including plumbing	Drinking fountains replaced	Fence at the front of school (School Safety)
Replace portables (Health Issues-moldy)	Build a gym	Shade structure in Kindergarten area
Remodel room 22 to have office & storage (AM & PM K)	Locks on restroom doors	Drinking fountain on Kindergarten playground
Covering between breezeway (between rooms 8-10 & 13-16)	Automatic flushers	Remodel intermediate courtyard rooms
Restroom attached to room 27 (SH classroom)	Hand dryers	Covered bike racks
Heating and Air Conditioning updated	Replace basketball hoops	Storage (shed?)
Real Stage	New backstops	More goal posts with nets
Fence at the front of school (School Safety)	Replace edges in bark boxes	Electrical
Shade structure in Kindergarten area	Paint classrooms	Security lights (School Safety)
Drinking fountain on Kindergarten playground	More benches on playground	HD security cameras (School Safety)
Remodel Intermediate Courtyard rooms	Benches/tables under trees by bike rack	Electrical drops in classroom (update electrical)
Covered bike racks	Repaint playground	Infrastructure-replace backbone with fiber optics (Most needed)
Heater in men's restroom	Repaint a standard size basketball key	Yard Maintenance
"No peak" panels in women's restroom	New swings	Intermediate courtyard redone (School Safety-tripping hazard)
More goal posts with nets	New or update stage	Level field between goal posts to eliminate mud hole (Most Needed)
Electrical	Electrical	Level out track, replace with better materials (Tripping Hazard)
Security lights (School Safety)	Security lights (School Safety)	Safety Materials
HD security cameras (School Safety)	HD security cameras (School Safety)	New blinds for Kindergarten
Electrical drops in classroom (update electrical)	Electrical drops in classroom (update electrical)	Technology
Infrastructure-replace backbone with fiber optics (Most needed)	Infrastructure-replace with fiber optics (Most needed)	Update computer lab
Yard Maintenance	Yard Maintenance	
Intermediate courtyard redone (School Safety-tripping hazard)	Intermediate courtyard redone (School Safety)	
Level field between goal posts to eliminate mud hole (Most Needed)	Level field between goal posts (Most Needed)	
Level out track, replace with better materials (Tripping Hazard)	Redo track with better materials (Tripping Hazard)	
Fix or replace blacktop	Fix or replace blacktop	
Technology	Technology	
Update computer lab	Update computer lab and TV equipment	

Citrus Elementary School

(Facilitator: Ellen)

- When choosing a School the following things are a priority:
 - Clean School
 - Good Fencing
 - Computers/iPads
 - Good Furniture
- Don't really need TV's, but need more computers!
- More computers in the Library & Computer Lab
- Need another "learning lab"/computer lab
- We need solar panels to power our school
- A.R., Help Math, Rosetta Stone which need computers
- Shade structure in the playground is needed
- The main building needs better AC
- Need a fence between the main building and the D & B Buildings
- The main building is 75 years old
- Projectors should be mounted on the ceiling instead of on tables
- Get rid of cords on the floor
- Need more drinking fountains on the play ground closer to the grass area
- Need a new roof (green color to match trim)
- Dogs are able to get onto the campus which can be dangerous
- There are no parking, bus lanes, or kindergarten drop off
- Need windows in the D Building
- Need new play equipment
- Need Flooring and lights replaced
- Update the technology
- Need outdoor lights and video cameras
- Improve the AC on the north side of the main building where rooms get hot

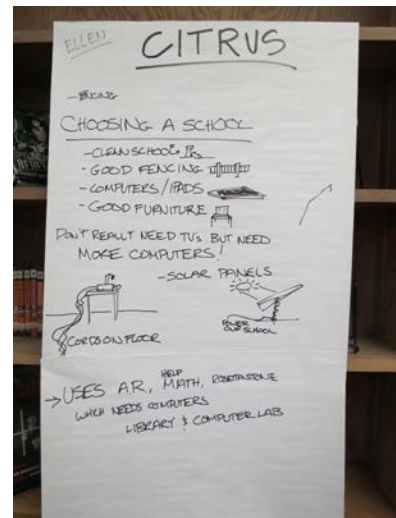
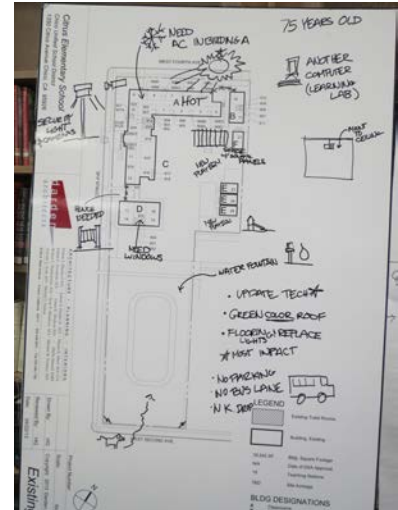

MEASURE E SCHOOL SITE SURVEY

Conducted prior to community input meeting and provided to design team

Citrus Elementary School:

Staff and P.T.A Recommendations	
Fencing (security; keeping campus closed)	Outdoors-repainting arts & painting on walls, playground and hallway
New roof- green	Shade structure outside
Update clock/intercom system	Remove portables
HVAC system-including heat in book room, science room, room 22 and other small rooms	Remodel kitchen
Air conditioning and ventilation in main building	Play area wood box needs repair
Fire Panel	Replace lighting with 4' lights in annexes
Flooring throughout campus	Windows worn and paint chipped-most need refurbishing or replacing
New carpet in classrooms	Books for classrooms
New flooring in the hall and multipurpose room	Books for library
Technology	P.E. equipment
Projector ceiling mounts	Update playground equipment (safety)
Smart boards and mounting equipment	New playground structures
New computers and laptops	New playground equipment
New projectors (touch screens)	Off street parking
New computers for office	Bigger library
Sound equipment for outdoor/indoor (stage) use-- microphone, stereo, etc.	Patio cover over picnic tables with solar panels on top
Laptops for teachers	Better basketball hoops
More walkie-talkies	Covered walkways from Kinder to main building
Cabling, wiring and Wi-Fi in all classrooms	Improve the PA system so it can be heard outside
Other Projects	Bigger custodian office/closet
Expand cafeteria/gym with repainted game lines on floor	Put gates on the end of the field
Roof covering over lunch tables outside and new tables	New covered walkway from main building to library
Clean/replace ceiling tiles in classrooms 13-16	Replace wood borders on playgrounds
Working security cameras around campus	Windows in indoor bathrooms
Update existing classrooms	New gutters on Kindergarten building
New TV's and Blue Ray dvd players	Deeper drains on the playground
New marquee	

Emma Wilson Elementary School

(Facilitator: Nick)

- Need more band width for Technology Infrastructure
- Need more computers in classrooms
- Current "List" (the brochure handout) is General priority needs except:
 - Flooring replacement
 - 4 security items (especially fencing)
 - Bathroom upgrades
 - All three items above are equally #1 priority
- Need a shade structure for 100+ students at lunch west of existing Multi Purpose Room at the bike racks, so relocate bike racks
- Re-grade major play field and use some of the soil from the courtyard to remove mound, it's a hazard now
- Deal with existing trees that are infected, perhaps we need new trees? This is a major maintenance issue
- Coordinate possible future solar panels with students needs for covered seating, eating & play structure areas
- Replace single-pane windows with thermal-panel, do L.C.C. analysis to determine payback period
- Repair water leaks at Building E and parts of Building B
- Repair/upgrade all existing casework
- Paint inside and out

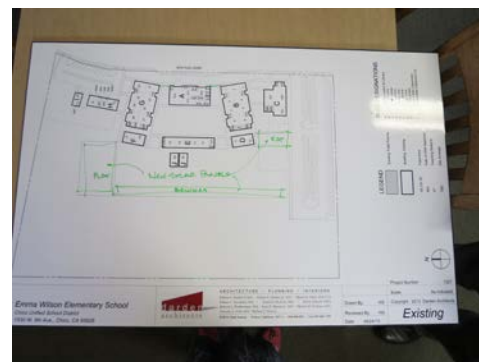
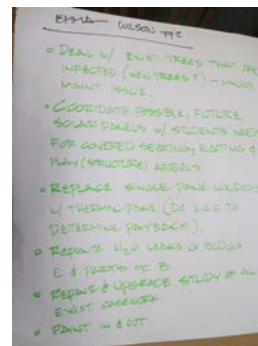
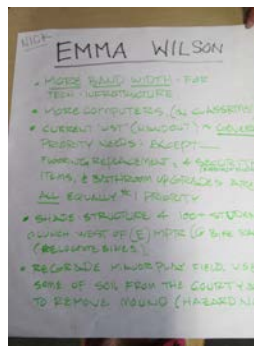

MEASURE E SCHOOL SITE SURVEY

Conducted prior to community input meeting and provided to design team

Emma Wilson Elementary School:

Staff Recommendations	
Flooring throughout school/office: carpet and tiles	Abatement of vermin-termites, roaches, mice and rats
Security fencing around entire school	Weather stripping on doors in portables to reduce flooding and pests
More security cameras	Talkies for teachers
Motion sensor lights all around campus	Regulate temperatures in classrooms: too hot or too cold
Blinds/curtains in front office--vulnerable during a code red	Repair broken rollers on storage drawers in classrooms
Repair, replace, paint and update bathrooms (sinks, urinals-auto flush, fixing stalls, partitions between urinals, electric hand dryers, better lighting, non slippery flooring)	Paint goal posts
Replace or repair drinking fountains and additional drinking fountains	Classroom curtains cleaned
Level sidewalks: tripping hazard	Window-dual pane (ones that will open and close)
Shade structure	New counter tops
Painting (Interior: all classrooms, office and MPR; Exterior: Siding on portable classrooms)	Running track (like Rosedale)
New/updated technology	Picnic tables for kindergarten playground
Repair the field so it's not so uneven and bumpy: unsafe pothole problem	New window screens
Fix leaky roofs and drain pipes	Doors in back of rooms 12-15 to get outside in an emergency (or get in from the playground)
Alarm key box moved to front of building where it is lit and visible	Fix closed circuit TV system
Ability to lock common areas adjoining rooms	Remote TVs: update with flat screens
Covering over sidewalks leading into the MPR (lunch entry point) for rainy weather	Custodial Recommendations:
Replace or treat diseased trees (aphids?)	Interior paint
Check walls for mold	Flooring: carpets
	Air vents to custodial closets
	Move hot water off of the floor to create more space
Student Leadership and Student Recommendations	
Fix bad works in slides from permanent damage	Repaint cafeteria
Repair the field so it's not so uneven and bumpy: unsafe pothole problem	Repaint goal posts
Replace existing and add extra drinking fountains	New taller food bar
Update bathrooms (walls between urinals, sensor flush toilets, paint, replace toilet paper dispensers and stall walls, paper towels, better lighting)	New food trays for cafeteria/bigger trays
Repair or replace wood where grass meets blacktop	Deadbolt locks on doors
Add landscaping so there is less dirt	
Parent and PTA Recommendations	
Safety fencing around the entire school	Cover walkways leading into the multi-purpose room so children don't get wet waiting for lunch on rainy days
Repair the field so it's not so uneven and bumpy: unsafe pothole problem	Update bathrooms (auto flush toilets, hand dryers, walls installed between urinals)
Shade cover for the courtyard area	Replace existing and add extra drinking fountains
Curtains: clean or replace all due to being dirty and/or finding spiders hiding in them-add curtains in front office-Code Red Safety Issue	Improve facilities heating and air conditioning
Replace carpet in all classrooms and tiles elsewhere	Update cafeteria
	Fix closed circuit TV system

Rosedale Elementary School

(Facilitator: Tim)

- Red tape of District to do things
- Self management decentralize
- Like fruit trees ... for science

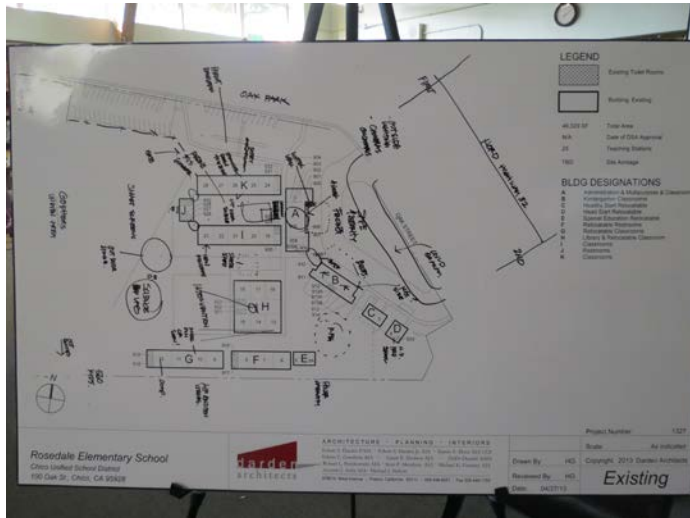

MEASURE E SCHOOL SITE SURVEY

Conducted prior to community input meeting and provided to design team

Rosedale Elementary School:

Staff Recommendations	Leadership Input	Technology Team
Health and Safety	More water fountains	iPads for teachers-searching, pictures, email
Drop off and pick up	Closed campus-fences & gates	Laptops for all students for assignments, writing, typing
AC in portables	Surveillance cameras	Updating network--speed, not losing work
Duct-cleaning	More trees	Better computers for the computer lab & teachers
Gopher holes-owl boxes	Curtains in classrooms	Better computers for teachers (faster) no wasted ed. time
Drinking fountains-repair, Kinder	Playground rocks	Technology for sicknesses or disabilities, no missing school
Curtains	Grass on field/gophers	iPads for students so they don't waste paper
Fences around campus	More recycling bins	Learning games
Outside lighting for security, (parking lots)	Efficient light bulbs	iPads for intermediate kids
Baseball backstop out or upgraded	Solar power	Learn responsibility
Hot water to classrooms	Self flushing toilets	Check out laptop/device to take home
Maintenance	Not using as many lights	Student ID cards (library) with permission slips
Ceiling/roof 24	Fences around the school	Better TVs for classrooms
Doors out of courtyard	Leaky roofs (room 11)	
Doors in K bathrooms	Better drainage in bathrooms	
Rm 1 Kinder back doors	Bathrooms	
Painting	Bolts on playground	
Drainage-ground-gutters	Air conditioners	
Technology	Light bulbs	
Laptop instead of desktops for teachers	Cafeteria-more like gym	
Printers in classrooms	Bigger portables	
Key boarding software	Air fresheners	
Software	Larger cafeteria	
Modernization	Perm. bldgs instead of portables	
Wiring	More spinning on playground	
Curtains? New/clean	Better bathrooms	
Boiler room-better use of space?	Faster and better computers	
Classroom furniture	Cameras for student groups	
Energy Efficiency	New TVs	
Windows-safety, modern, dual pane		
Composting		
Power conditioner		

Staff Recommendations	Leadership Input	Technology Team
Automatic computer shut down		
Dreams		
Science Lab		
Gym		
Bigger cafeteria with stage		
Outdoor covered seating		
Science oriented garden		
Storage behind portables		
TV/audio production		
Prep room		
Conference room		
PE equipment		
Air compressor		
Large display cases		
Pre-school Immersion		
Leaf vacuum		
More trees		
Cabinet in classrooms		
Counters		
Synthetic track		



Chico Jr. High School

(Facilitator: Marty)

- Technology Infrastructure
 - Wi-Fi, iPads by teachers, more band width, power too
 - Communication tool including Smart Boards in Gym & PE as an education tool
- 80 to 150 students in PE
 - They must put students in MPR & Room 505
 - Fields
 - Gym too small
 - Lacking space for after school programs & sports competitions
- Field House, Mats, Aerobics, Weights, Activities
 - Fields, gopher holes, grass, Athletic equipment
 - Dangerous conditions! Irrigation System!
- These additional spaces would have multiple uses. A real impact (positive). MPR is impacted.
- Security Issues include:
 - Strangers on site all night still there in the morning
 - Eliminate the alcoves and hiding places
- Courthouse across the street creates disruption. Separation needed
- Fields are large to the north, but not planned well for use
- Need new intercom; current one goes out in places
- Student commons area would be used
- Southwest corner of site is wide open; good place for future facilities
- Multi-Purpose stage is NOT used. It's a storage area
- Drama & Dance programs are not supported with performance spaces. Music needs performance space too
- Bike rack is not in a good location and fence is not very secure
 - Replace bike rack area with corporate yard for Industrial Technology
- Covered walks (wood) need repair and replacement
 - Gutters, Gym overhang at walks need work
- Locker Room needs modernization
 - Showers are broken, cracked, ugly
- Media Center is needed in Library
 - More access to computers in Library
- Staff toilets are in need of attention
- Roof leak in Room 505
- Updating windows with 2 panes
- Bike path to racks
- West parking needs rework – the worst!
- 3 busses mix with parents
- Faculty mix with drop-off
- Limited parking by Gym and all events
- Concrete pad for graduation and other events
- 624 students

- Seating for students make park-like
- District is housed in portables – Building G
- Gym’s east and west walls have leaks and water stains
 - Causing damage to wood gym floor
 - Paint bubbles trap water then break
- Drinking Hydration Stations
 - Drinking Fountains
- Lack of power outlets – campus wide
- Lack of data jacks – campus wide
- Student toilets need renovation
- Classrooms need hardware that can be locked from inside
- Security cameras & mirrors
- 3 Locker Rooms
- 1 Field
- Need grass
- 2 Awnings
- Need new desk and tables
- Need to add or upgrade two more classrooms into Science labs. They currently have 2 labs

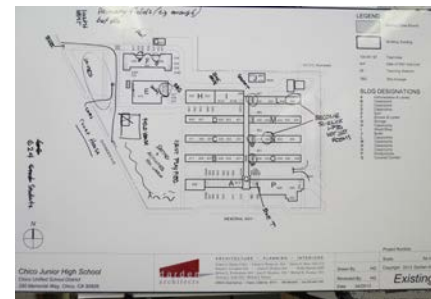
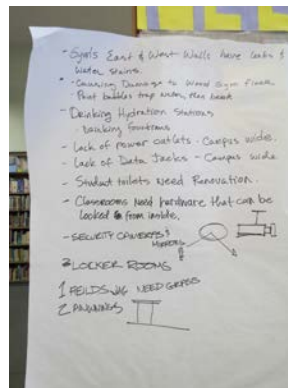
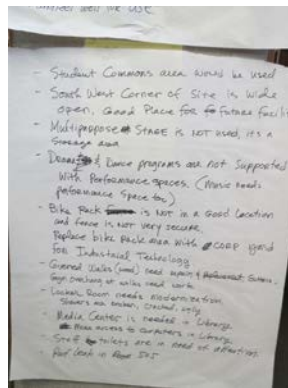
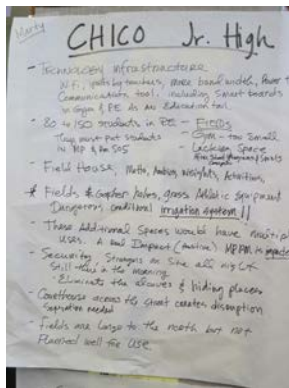

MEASURE E SCHOOL SITE SURVEY

Conducted prior to community input meeting and provided to design team

Chico Jr. High School:

Staff Recommendations
Replace/fix/re-roof hallway overhangs
Redo entryways into the boy's and girl's locker rooms
Update the boy's and girl's locker rooms
Update library carpet and create central computer lab in library
Update 505
Fix leaks in Media Center in 505
Fix leaks in gym/new addition
Replace all drinking fountains install bottle refill stations
Update electrical power to accommodate computer labs in all the classrooms (preparation for possible 2014-15 Computerized State Assessment)
New infrastructure in the classrooms to accommodate more computers
Remodel bathrooms in the main hallway
Redo all locks to all the classrooms to allow them to be locked from the inside

Hooker Oak Elementary School

(Facilitator: Haley)

- 60-year old building with asbestos. Old building is difficult to maintain
 - Floors cracking/buckling; issue with current ADA student
 - Electrical issues; blown fuses in winter
 - A/C at wing 1 is loud
 - Hallways not heated/cooled
 - Windows are single pane
- Technology Needs:
 - New server, but hard to keep up with constant change in technology
 - 5 Smart Boards – older versions hard to upkeep
 - Would be great to have more computer labs; mobile computer lab would be great
- Play Fields are uneven and full of gophers
- Parking is limited
- Safety Issues:
 - Administration view is limited to be able to watch who comes in/out of building
 - Gates locked/doors locked to force flow of people into main entry on Arbutus Avenue
 - Main drop-off on 3rd Avenue disconnected with entry
 - Visual advantage point from Administration
 - Traffic issues with flow
 - Sun shade over lunch tables
 - Ability to be locked campus helps with safety – fence all around campus currently helps with safety
 - Flooring issues create trip hazards
 - Leaking issues during rainy months causes slippery floors
 - Bays RR's floors weren't sealed = yucky smell
 - Old trees create hazard of falling on buildings
 - Exterior lighting
 - Flooding issues
 - Basement is scary – rats – boiler room
- Kindergarten Class size has changed SF requirements
 - D18 Room is too small
- Facilities Improvements that have the most impact:
 - Tear it down; not worth saving?
 - New floors, windows (thermal issues in winter), painting
 - Fix the leaks
 - Improve parent pick-up/drop-off
 - Beautification would have impact
 - Modernize spaces; it looks/feels dingy & old
- Appears to be kept up and clean and maintained
- Learning environment is large enough for various activities to occur
- Technology improvements throughout
- MPR is too small
- Cramped Administration space makes it hard for staff

- Need professional help with upkeep of
 - Garden
 - Nature center
 - Nice to having parent help, but professional
- More storage would be helpful
- Common core testing is coming
 - Flexible teaching areas
 - Testing is coming via computer – need to be able to teach kids computer skills so they can
- Currently we like our stage and some of the large classrooms

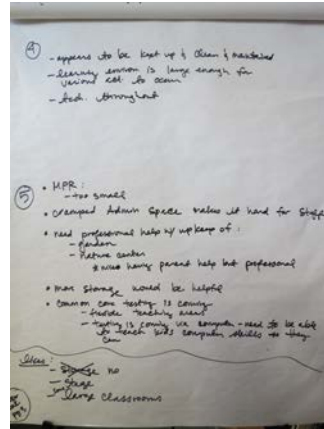
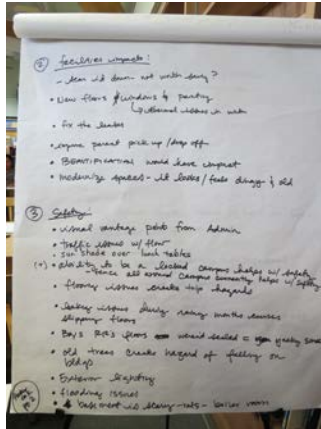
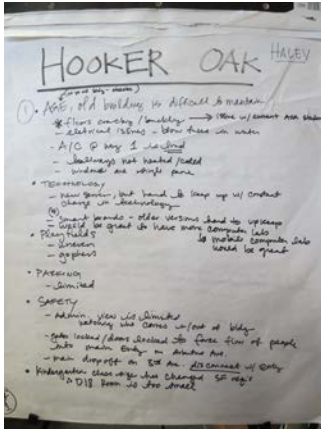

MEASURE E SCHOOL SITE SURVEY

Conducted prior to community input meeting and provided to design team

Hooker Oak Elementary School:

Staff and Parent Advisory Board Recommendations	
Kitchen floor needs total resurfacing/rebuilding	Replace carpet in Kindergarten room 18 (it is buckled, grungy and torn)
Kitchen ovens don't work well	Linoleum cracking, buckling crack widening at entries of wings 1 and 2
Wing 3 restrooms are dark and dank	Building inside and outside needs painting
Ongoing multiple leaking ceiling areas; roof replacement needed	No hot water in health room
Electrical circuitry is old thus does not support technology infusion; circuits are blown almost daily	Parking lot floods
Window frames to garden and nature areas have decaying wood	Blacktop area near basketball area floods
Hallways and office rooms are freezing	Area by bike racks flood
Wing 1 and 2 boy's restroom tile replacement	Need dual pane windows to decrease heat and air conditioning loss in the building
Only one outside water fountain for students	Adult restrooms antiquated (no doors in women's restrooms)
Concrete foundation and walls have separated; water and ants entry	Trees in Nature Center need professional trimming as they are too close to building
MPR/Cafeteria drop down tables are aging & nearing obsolete status for parts	Cabinetry in halls is ancient, warped doors, need built-in storage for every classroom
No hot water in adult restrooms (heaters installed but see no difference)	

Staff and Parent Advisory Board Recommendations	
Access to roof of building by low kitchen overhang needs to be eliminated	Replace rotting eaves
Outdoor eating area needs warm weather tenting sun protection	Repaint all of building in and out
Main office is outdated and cramped	Repair unusable drinking fountain outside
Safety access into building needs modernizing per safety needs of the times	Replace missing curtain on stage
Not all classrooms have LCD projectors mounted	Strip and re-stain and wax stage flooring
Laptops for all teachers needed	Water bibs needed on portables
Replace bathrooms floors	Remove tall cypress trees next to the buildings
A/C needed in kitchen (presently just has an old swamp cooler)	Remove trees outside wing 3 (drop debris into eaves, blacktop stopping up drains)
Replace dishwasher	Fix outside drainage problems
Seal and upgrade basement	Remove boiler room asbestos and old boilers
New classroom wire and circuit breakers	Repair inside and outside custodial mop drains
Replace MPR chairs and racks	
Plane the playing fields and level out (renovate)	

Chapman Elementary School



(Facilitator: Mike Cannon)

MEASURE E SCHOOL SITE SURVEY

Conducted prior to community input meeting and provided to design team

Chapman Elementary School:

Staff Recommendations
Replace kindergarten asphalt
Secure the kindergarten fencing
Carpets replaced with tile in classrooms
Women's restroom/children's restroom with better lighting
Power washing
New playground equipment for kindergarten and main playground
Painting
Ramps
Awning by multipurpose with built-in picnic tables
More portables with bathroom facilities
Wall against park--beautify and secure us
Kindergarten portable with bathroom (reclaim room 19)
Computer stations built-in
Landscaping--shade trees
A computer lab
Track for around the field
Drinking fountains
Asphalt leveling by ????
More outlets and upgrade
New desks and chairs
A different teacher's workroom --renovate and equip

Bidwell Jr. High School

(Facilitator: Marty)

- Technology – Use of Smart Boards
 - Helps describe what the message is with videos, photos, real world on internet
 - More Power and Data
 - 21st Century technology is needed
 - Whole new infrastructure
 - Wi-Fi coverage not campus wide
- Improvements to the Appearance:
 - Curb appeal overall at the school
 - Front of the school
 - Maintenance, cleaning, painting, modernizing
 - Get the asbestos out
 - Engage students with technology
 - Technology improvements needed to meet the new testing requirements
 - Revamp the Greenhouse
 - Gym upgrades, ventilation, floor, paint, lighting, technology, Wi-Fi
 - We want our students to take care of facilities so we need to lead the way
- Student Commons south of 400 wing lacks student site amenities
 - Benches, muddy, no shade, there's a drainage issue in this area
 - This is a high-profile area
 - This needs to be a better place for kids
- Sports Fields Improvements:
 - Gopher holes, irrigation needs
 - Sand volleyball, track, soccer goals
 - Bike path needs repaved!
 - Lines painted on play courts, nets on basketball hoops
- New lunch tables are needed
- Cafeteria, Main Office need modernization
- Library needs to be larger
- Being prepared for lock-down
 - What exists is not efficient way to lock room
- No electronic marquee
- Replace chain link security fence with new iron fence
- Crosswalk in front of office to safely cross North Avenue
- Bike rack can be smaller, but more secure
 - The bike racks are bent too
- Container storage behind Gym leaks and should be replaced
- Remove chain link on windows
 - Looks like a prison
 - Use secure glazing
- Student toilets need to be renovated
- Toilets in Building 308 sewer backs up and stinks

- Separation between cars and buses could use permanent separation (possibly a fence)
- PA System is loud or not loud enough
- Lighting in entry is low
 - It's not very well lit at night
 - Exterior security lighting
- Camera system needs to be replaced (security camera is old)
- HVAC System campus-wide is always breaking and noisy
- Office area has lots of needs
- Library carpet needs to be replaced
 - The Library looks like it did when school was built
 - Get asbestos out
- More computers in classrooms
- Ceiling leaks in computer labs
- LCD projectors all need to work
- Electric hand dryers probably would work better
- More local control in classrooms and other spaces
- Some drinking fountains don't work
- Some windows on north side and office have BB holes
- Consider the flooring standard for classrooms
- Display cases don't match in Main Entry
- Art Room needs a makeover
- Gutters need to be cleaned out
- Build a running track
- Bring Home EC room into the 21st Century

BIDWELL ①

- Technology - Smart Boards
- Classroom Storage Behind Gym Locker and Should be replaced
- Remove Chain Link on Windows it looks like a prison. Use Security Glazing
- Student Tablets need to be provided
- PA system is loud (or not loud enough)
- Lighting in entry is low. It's not very well lit at night. Exterior Security Lighting
- HVAC system Campus wide is always breaking & noisy

Student Commons South of deck using lockers Student Site activities

- Books, books, no shade, needs a drainage
- This is a high profile area
- This needs to be a better place for kids
- Sports Fields - open team, require needs
- Sand today will create, sand, concrete, gravel
- Extra path, needs improvement!
- Been painted on playground, mats on bike path
- Cafeteria, Main Office needs modernization
- Library need to be larger
- Being prepared for lock down
- What all doors in not relevant way to lock them
- No Electronic Signage
- Replace Chain Link Security fence with 100' Iron fence
- Campus walk at in front of office, to gym, cars, buses are

Office area has lots of needs.

- Library Carpet needs to be replaced
- The Library looks like it did when school was built
- Get asbestos out
- More Computers in Classrooms
- Ceiling leaks in Computer Labs
- LED projection All need to work
- Electric hand dryers probably would work better
- More local control in classrooms & other spaces
- Some Drinking fountains don't work
- Some windows on north side and office have BB holes
- Consider the Flooring Standard for Classrooms
- Display cases, cases don't match in Main Entry
- Just Ren needs a make over
- Lighting - recessed
- Gutters need to be cleaned out
- Build a running track
- Bring Home to Home into the 21st Century

Office area has lots of needs.

- Library Carpet needs to be replaced
- The Library looks like it did when school was built
- Get asbestos out
- More Computers in Classrooms
- Ceiling leaks in Computer Labs
- LED projection All need to work
- Electric hand dryers probably would work better
- More local control in classrooms & other spaces
- Some Drinking fountains don't work
- Some windows on north side and office have BB holes
- Consider the Flooring Standard for Classrooms
- Display cases, cases don't match in Main Entry
- Just Ren needs a make over
- Lighting - recessed
- Gutters need to be cleaned out
- Build a running track
- Bring Home to Home into the 21st Century

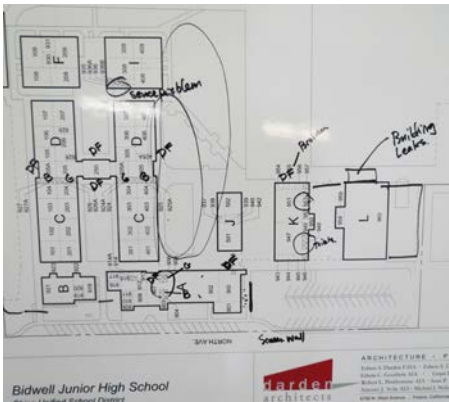

MEASURE E SCHOOL SITE SURVEY

Conducted prior to community input meeting and provided to design team

Bidwell Jr. High School:

Staff Recommendations	
Upgrade water drainage systems (400 wing)	Water fountains
New gym floor	Fix bb gun windows
New gym lighting	Fire drill numbers clear
New HVAC in gym	Carpeted classrooms
Fix fields/flatten	Bathroom sinks and stalls
Hot water in bathrooms	Digital Marquee
HVAC upgrade in all buildings	Display cases
Update office	Art room lockers
Move technology for common core testing	Art room shelves/countertops
Men's restroom in the 200/300 wing	Gutters
Less chain link	Running track paved
Move garbage away from gym	Shipping containers
Bike racks needed	Working irrigation
Lawn maintenance	More sustainable yards and grounds (i.e.: compost grass clippings at all large campuses, upgrade District equipment, mowers with pick-up ability)
Beatification of campus	
Complete Wi-Fi throughout entire campus including gym	Cargo containers on back of campus removed
Counseling, main office, health complex remodel	REUSE what the schools/District already have, repair, recycle broken stuff
Replace antiquated locks	
Smart Boards, computer/iPads	Fix staff bathrooms (heat and hot water, plumbing)
Carpet in library	Fill holes on access road by 100 wing
Lobby-dark, dingy, flooring, color	Remove bullet holes in Library and other rooms
Main office-take out swinging half door	Sandblast and repaint the fairy wall
Improved lighting in hallways=safety	Front boy's and girl's bathroom
Clear ceiling over main hall	Fix bell/clock system
Technology-rolling carts with laptops	Fix tables in lunchrooms
Projectors for all classrooms	Increase curb appeal (paint, downspouts, cyclone fence by bike rack, new hallway doors)
Remodel bathrooms in entrance (main lobby)	Finish wrought iron fence
Handryers	Remove paint/spray paint from windows
Thermostats in classrooms-teachers get sick because in winter they blow cold air	Check plumbing in the science room

McManus Elementary School

(Facilitator: Mike)

- Vehicle Pickup & drop-off very bad-3 rows of cars parked on street, plus parking lots at front & back of school impacted
- No parking for drop-off/walk-ins for Kindergarten
- Replace oldest (25 yrs. +) portables
- Fence the campus to improve security
- Better campus lighting to improve security
- Expand/renovate student & staff bathrooms
- Upgrade electrical & plumbing capacity
- Shade structures are needed throughout campus s



MEASURE E SCHOOL SITE SURVEY

Conducted prior to community input meeting and provided to design team

McManus Elementary School:

Staff Recommendations
Improve the parking and traffic safety for the campus. Before and after school student drop off and pick up times are difficult.
Rebuild/construct new utility shed on campus for P.E. equipment storage.
Improve night lighting for safety.
Put planter boxes in areas between classes.
Repaint the school.
Refurbish the student and staff bathrooms. They have not been renovated in many years.
Replace the wood chips in the playground areas with rubberized fall zone material.
Put a jogging track on campus.
Fix the gopher holes on the play fields.
Fence the entire campus. Put locking gates in the spaces where the fencing is currently open.
Upgrade the school's electrical capacity. This includes adding additional outlets in classes and making it so the breakers do not trip as easily.

Marigold Elementary School

(Facilitator: Nick)

(NOTE: Turnout at this Table: 2 past parents, 1 past student, 1 principal from McManus with daughter attending Marigold)

- Replace or modernize portables (L & G)
- Ramps: Covers over and skid proof
- Remove WHT trailer; replace with permanent construction
- Re-do Health Office and ADD Toilet (High Priority)
- Cutting edge instruction delivery
 - No Smart Boards; Maybe networked iPads or tablet PCs
- ADD Surround-sound in all teaching stations and give teachers headgear with mike
- Question on higher perimeter fence for secure site. Investigate other approaches

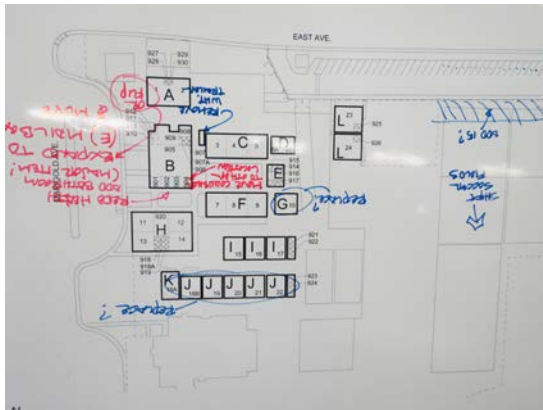

MARIGOLD

(NOT IN A PRIORITY LISTING)

- REPLACE OR MODERNIZE PORTABLES ('L' & 'G')
- RAMP: COVERS OVER & SKID PROOF.
- REMOVE WHT TRAILER; REPLACE W/ PERMANENT CONST.
- REDO HEALTH OFF. & ADD TOILET. (HIGH PRIORITY)
- CUTTING EDGE INSTRUCTION DELIVERY (NO SMART BOARDS; MAYBE NETWORKED I-PADS OR TABLET PCs). ALSO, ADD SURROUND SOUND IN ALL TEACH. STATIONS & GIVE TEACHERS HEAD GEAR W/ MIKE.
- QUESTION ON HIGHER PERIMETER FENCE & SECURE SITE. INVESTIGATE OTHER APPROACHES.

MEASURE E SCHOOL SITE SURVEY

Conducted prior to community input meeting and provided to design team

Marigold Elementary School:

Staff Recommendations	
Maintenance/deferred maintenance with an emphasis on immediate Health and Safety Issues	Modernization
Paint the entire school	Remove asbestos in all permanent buildings
Replace tables and benches in cafeteria/MPR	Replace carpet in the office
Redesign Health Office to include a bathroom	Replace all portables with permanent building
Blinds in all classrooms (Code Red)	Replace all student desks and chairs
Check for mold and wood rot in all portables	Re-landscape the courtyard area
Outside hooks for backpacks to eliminate trip & fall hazard	Widen the sidewalks in the courtyard area
Add an outside door to room 23 (SED)	Repair or install drainage outside of room 25 and room 16
Put a slip free surface on all ramps	Repave asphalt
Remove all old wiring and pipes	Upgrade HVAC system in all permanent buildings
Remove condemned white trailer and replace with a permanent building	Energy Efficiency
Increase the height of all fences and completely enclose the school with fencing to ensure one entry point during school hours	Replace lighting with more efficient bulbs and fixtures throughout the school
Technology	Install solar panels over both parking lots and the courtyard or on the roofs of all buildings
Upgrade all teacher, student, and administrative computers including those in the computer lab	Install more insulation in permanent buildings
Install ceiling mounts for projectors in all classrooms, computer lab, library and cafeteria	Upgrade HVAC systems in all buildings
Install Smart Boards in all classrooms	New Construction or other projects
Hire computer tech to maintain and teach	Repair or replace ramps
Each class needs a set of iPads	Enclose all ramps
Document readers for all classrooms	Replace portables with permanent building
Replace broken headphones in computer lab	Support classroom and office supplies in one location
Laptops for all teachers and students	Second building for SED class
	Lower the sinks and raise the counter tops in all kindergarten rooms

Shasta Elementary School

(Facilitator: Haley)

- Too many relocatables
- Main building has its own set of issues
 - Outdated RR's
 - (2) in Bldg. B are small
 - (2) in Bldg. C are plenty large
 - Outdated technology infrastructure
 - Alarm problems
- Portable issues
 - All completely different styles
 - Get rid of and replace with permanent building
- Need space to do outdoor science projects
 - Outdoor learning center where kids can learn would be desirable
- Need more learning space
 - Open up existing area for outdoor space to learn
- Site issues of circulation
 - Property next door is available
- Great kitchen currently
 - It was replaced after a fire
- Shade structure needed on playground
 - Currently only have trees
- Improving the back parking lot with drop off/pick up is happening this summer
 - Losing parking
- Get rid of portables and have permanent buildings that make better usage of the site and better relates/integrates with existing buildings
- Save the quad
 - It's part of the school's history and identity
- Computer lab could be bigger to accommodate growth and the eventual move by the state to online testing
- Technology
- Parking improvements need more parking
 - Need better flow for drop off/pick up
 - Some parking happening at the empty lots nearby
- Section 8 housing nearby will have impact on influx of students walking to this school nearby
- No sidewalk at Esplanade parking lot
- Existing play area at corner is a busy street
- No substantial fence
 - Kids play on fence too
 - Kids stand on play equipment that is adjacent to the fence = NOT SAFE
- No fence at interior drop off/pick up area
 - Dangerous for kids
- Fence along Esplanade gate is not locked

- Disconnect between crosswalk and where students are crossing on Esplanade and actual crosswalk at stoplight
- Illegal U-turns happening out of lower parking lot onto Esplanade
- Gate at Esplanade parking lot will be locked next year for safety
 - It's an area that can't be seen or supervised
 - Parents park there for Kindergarten pick up
- MPR that can handle all the kids at one time
 - Maybe an outdoor covered area
- Shade structures/Solar structures
 - Offer flexible space for outdoor learning and outdoor eating area
- With more development happening in surrounding area, there may be future growth to anticipate
- Add marquee to other side of school so they can communicate what's going on at school
- TK: how will it affect the need for space to possibly house them in the future

SHASTA

①. Too many stakeholders

- Main building has its own set of issues
 - Childcare RPT - (2) in Site B are gone
 - outdoor deck re-configuration
 - alarm parking
- Portable toilet - currently, distance
 - get rid of and replace by permanent toilet
- Had space to do outdoor welcome projects
 - make Community Center where kids could learn and be educated
- Had nice screening space
 - open up (B) area for outdoor space to learn
- Site wishes to be accessible
 - temporary road down use accessible

②. Open question currently (is not answered after a fire)

- Shade structure needed for playground, currently they have trees
- Improving the back parking lot with short off front up to drop-off area - remove existing parking
- get rid of portables and other permanent things that really better usage. better who are better suited for separate walk (to) drop-off
- See the road - get part of the school building and identify
- accessible - could be bridge into backhills quad and use outdoor more legible area for more activity
- Technology
- parking improvements used more parking, need better flow for drop-off, pick-up, some parking improvements to accommodate more drop-off
- Some 3rd party may not have computer on website - include safety, physical plan for accessibility of Esplanade parking lot

③. (E) drop-off @ corner lot & bring about

- No asphalt/paved space, kids play on concrete, kids stand on lines, equipment - drop-off adjacent to fence - get edge
- no space @ children drop-off/parking area - drop-off for kids
- fence along Esplanade not needed
- disconnect between driveway and other adjacent area - drop-off in Esplanade and adjacent to fence
- adjust entrance driveway out of drop-off area into Esplanade
- gate @ Esplanade parking lot that will be closed but open to allow an area where kids to drop-off/pick-up
- possible photo zone for drop-off/pick-up

④

- MPR that can handle all the kids @ one time!
 - maybe an outdoor covered area
- Shade structures / Solar structures
 - offer flexible space for outdoor learning and outdoor eating area
- with more development happening in surrounding area there may be future growth to anticipate
- add marquee to other side of school so they can communicate what's going on @ school
- TK / RPT that will affect the road for space to possibly house them in the future

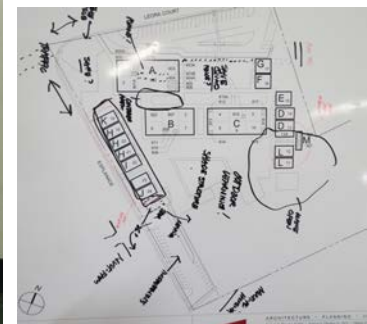

MEASURE E SCHOOL SITE SURVEY

Conducted prior to community input meeting and provided to design team

Shasta Elementary School:

Staff Recommendations
Renovate and modernize bathrooms
Replace portable buildings with permanent buildings
Mold removal in portables
Repair rams
Repair fields (front and back)
New carpet
Roof cover over breezeway
Add a fine arts or science room
Upgrade heating and cooling system
Roof repairs
Water fountains
Security posts in from of Kindergarten pick up area
Fencing in front of school
Add outdoor classroom
Improve parking and traffic flow

Neal Dow Elementary School

(Facilitator: Ellen)

- Bigger MPR with stage for music program
- The round house has small rooms for the class size
 - If the rooms in the round house could be expanded to the edge of the overhang then they would be big enough and windows could be added to this new exterior wall
- Need new surface in the parking lot
- Need a real mop sink for dumping water used for moping
- Would like to have solar in parking
 - Add lights to the parking lot
- Grades 1-2 need a fantasy play structure
 - Can't see playground at night because it is too dark which is a safety concern
- Need a more significant gate/entrance by the D Building because it is where a lot of students come into school
- Need to fix the ponding that occurs on the black top area between the A and C buildings
- Kids request are solved by the field improvements in the original list given to the District

Most Impactful change would be:

- Outdoor play area improvements
- Technology upgrades
- MPR stage
- Computer lab (Dedicate space)
- S.H.C. Building with safety and bathroom furniture
 - New building would be needed if the school was to get any bigger
- (What facilities do you look for in selecting a school?) - Middle School Choice:
 - Safety related
 - Mash looks like a modern school
 - BJR looks run down
- Kids spend the longest at elementary schools so this is where the Board should invest their money

What facility improvements would help your child learn:

- Need counseling rooms
- Need private meeting rooms
- Create a tie to community history in learning
- Give kids programs to engage them in elementary
- Bring interest into learning by providing computer labs and music rooms
 - Computer Lab
- Music Rooms
 - Example: San Diego shares between schools for special spaces
- Provide a nutritional information at lunch
- Provide a connection with the nurse and kitchen to talk about nutrition and health

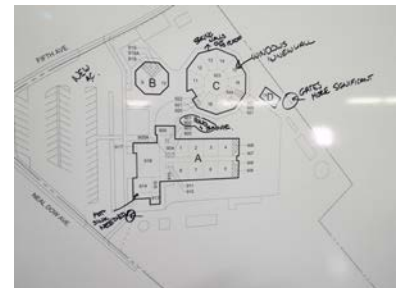

MEASURE E SCHOOL SITE SURVEY

Conducted prior to community input meeting and provided to design team

Neal Dow Elementary School:

Staff Recommendations	
Top of the list (Safety)	
Tint all windows in primary wing and office area to one way view from inside to outdoors	Replace back door in room 9 that never stays closed
Lockable gate needed on fence opening near bus stop and kitchen area	Efficient lighting at night around campus
Till and level grass areas	Fully fence the campus with one entry during school hours
Storm drain outside of portable building (huge lake of water during rain)	Duet blinds in rooms without curtains
	Repair huge leak in boy's primary restroom
School building/site needs	
Ventilation heat/air in primary hallway, speech room and ASES room in MPR	Bookcases in round house classrooms
Replace old AC and filters	Cut windows above round house classroom doors
Outside locked storage for bikes	Magnetic boards for primary classrooms (8)
More drinking fountains, with one in kindergarten area	Upgrade adult bathrooms
Fitness stations around the track	Replace kitchen stove (current one from 1960)
Hot water in classrooms	Double-paned windows and solar panels
Adequate classroom electrical outlets	
Deferred Maintenance Projects	
Maintain track quality	Re-do the parking lot holes
Modernize plumbing in bathrooms	Resurface blacktop between kickboards
Technology Needs	
Consolidate network cables/switch/router into server cabinet in AC math room	Laser duplexing printing for primary for AC Math
Network power, audio system, projector and computer for MPR	Replace kindergarten laptops
Convert a classroom into a permanent computer lab with 36 towers, smart board and audio system	Replace worn projectors (12)
Purchase laptops for teachers	
New Buildings Projects	
Bigger MPR to hold entire school with stage	PE equipment room/building
Amphitheatre	Shed behind kitchen
Fine Arts room	
Dreams	
New intermediate wing	Shaded areas for picnic tables (awnings)
Gym with PE storage	Covered bus waiting area with solar panels
Expand MPR into parking lot to develop stage, PE gym and fine arts rooms	

PTA Recommendations

Replant the grass play field with new sprinkler systems
Plant more trees on perimeter for shade
Build walls/doors to classrooms on the inside of the round house
Create a student designed play structure through a professional company
Soccer goals with nets
Drinking fountains on perimeter of playing fields and play structures
Paint the outside of the buildings

Student Recommendations

Repaint basketball courts	Higher fences	Student shop
Solar panels	Upgrade MPR	Statue of our mascot
Better slides	New stage	New play structure
Better computers	Chain nets	Bigger classrooms
Carpets	More trees	Bigger garden
Rebuild play fields	Paint field stripes	Dragon water fountain
More drinking fountains	Track fitness stations	Larger back boards
Repave ball wall blacktop	Enclose the round house classrooms	Tables/benches/for snack area/covered
Create a covered eating area	Benches around track	New barriers around the play structures
More swings	Electric pencil sharpeners in each class	Remodel bathrooms/air hand dryers
Better outdoor tables	Repaint the blacktop	Theater/stage/drama room
Build a gym	Rock climbing wall	Seats in MPR
Rubberize the track	Football uprights	More sinks in restrooms
White boards	Art room	Play structure helicopter
More spinning bars on play structure	Fix holes in the field	New goal posts
New speakers	Two story library	Playground spinner
Merry go round	Two story school	More uneven bars
Tire swing	Computer lab	Snack tables
Sports/PE equipment shed	Band room	New books
Real soccer goals with nets		

Pleasant Valley High School

(Facilitator: Ellen)

- Will ADA take all the money?
- Gym needs AC because of the following:
 - Too hot
 - No participation because it is too hot
 - It causes safety issue
- All Sports Fields:
 - Used by the other schools
 - Used by other organizations
 - Too much wear and tear on grass
 - Need more maintenance on grass
- Missing Student Culture without good quality sport facilities
- Too Many Access Points on site
- Like the Lighting in the Parking Lot
- Cars drive in Campus Core
 - Supplies
 - Safety
- Need a new Wrestling Room
 - Uses Football room so program cannot start on time
 - Equity should be provided between the high schools
 - This program engages kids
- Need a Gym Entry Way with a protected area for the Snack Bar and the Tickets
- Freshmen have no where to eat lunch
 - MPR is too small
 - It's original and it is OLD!
 - Would like something more like Chico High
- Campus has change, but Athletics has not changed
- Need to redo all of Football Complex
- Need a swimming Pool
- Need an engineering Lab
- Sports Medicine program is partnered with Enlow
 - Need a lab Space
 - Meet college entry 48%
- Create Community all sports stadium at this campus
 - This community is ready for events
 - This campus has lights and parking
- Common Athletic Field for both high schools
- Planetarium would be nice
- Locker Rooms need improvement
- We don't feel unsafe on campus
- Need a better Maintenance Plan
- Classroom improvements would include:

- HVAC
- Electrical
- Finishes
- Lights
- We have good academic program: I.B. and Academic D.
- Meet college entry 48%
- Busses need help, they are old with miles
 - This may be a General fund expenditure?

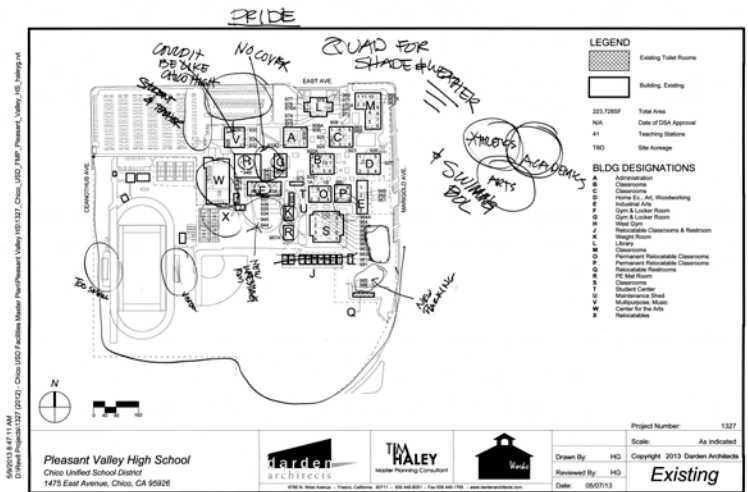

PVHS

- WILL ADA TAKE ALL THE MONEY
- GYM AC
 - TO NOT USE
 - SAFETY
- FOOTBALL FIELD
 - ALL SPACES
 - TO MUCH
 - TO MUCH
- MISSING STUDENT CULTURE
- DO MANY ACCESS POINTS
- LIKE THE LIGHTING IN PARKING LOT
- DRIVING IN CAMPUS CORE
 - SAFETY

- NEW WRESTLING ROOM
 - GYM FOOTBALL
 - COURT
 - ENSPACE KIDS
- GYM ENTRY WAY
 - SHUTTER
 - TICKETS
- FRESHMAN HAVENO WHERE TO EAT LUNCH
 - OPEN (OLD)
- CAMPUS HAS CHANGE BUT ATHLETICS HAS NOT CHANGE
- REDO ALL OF FOOTBALL COURSE
 - FOOT HILL
- SWIMMING POOL

- EXIST LABS
- SPORTS MED (PARTNER W/ ENDA)
 - LAB SPACE
- MEET COVERED ENTRY
- CREATE COMMUNITY
 - THIS COMMUNITY IS READY
 - COMMON ATHLETIC FIELD FOR BOTH HS
- LOCKER ROOMS
- DON'T FEEL UNSAFE
 - MAINTENANCE PLAN

- CLASS ROOM
 - HVAC
 - ELEC
 - FINISHES
 - LIGHTS
- WE HAVE IRS'S ACADEMIC D
- BUSES NEED HELP
 - OLD W/ MILES



MEASURE E SCHOOL SITE SURVEY

Conducted prior to community input meeting and provided to design team

Pleasant Valley High School:

Staff Recommendations			
Modernization of B,C,D,E and V buildings		core prep and testing	More storage
Repairs of the gym floors		More efficient HVAC units, Admin building	New tall seats for the drafting tables
Air-conditioning in the gyms/enclosed covering of the space in between the two gyms		Need stadium	New art desks or tables for D-4
Upgrades and new construction in the physical education and athletic facilities		Beautification: murals restored and the tile work fixed on pillars around school	Updated digital cameras (5), memory cards (5)
All-weather surfaces for athletic facilities		Modernize M-4 lab/classroom into an adjoin classroom (M-3?) for a green screen filming area for production	Ability to download things to computer/laptop without admin permission
Sufficient seating and restrooms for athletic facilities		Replace carpeting and paint Admin offices	Better outdoor lighting on the campus
3 additional tennis courts		New monitors for Audio/Video class in order to support new software	Fix the light system in storeroom in D-2 so it is not affected by lights in D-1
Team/Locker rooms		15 new tables for D-5, approx. 20" x 60"	Fix ventilation system in D building
Development of technology "bundles" similar to the ones intended for the new classroom building		Hire itech person to help us become more effective	Picnic tables and benches on campus
Upgrades of infra-structure and additional hardware upgrades to current technology in all rooms (TV, DVD, Smart Boards, CPX projector, ELMO)		Class sets of tablets, more computers	Sound proof windows for labs/classrooms
Repair leaky roofs		More laptops for student check-out in library	New white boards as needed
Testing center		DVD external burners	Welding Lab shade/rain covered structure
Cart with computer/iPads and other technology to accommodate common		Replace/Modernize computer lab in M-3 and accommodate more students	Hot water for Welding Lab
		Creative Suite 6 and Classroom in a Book for Photoshop (class set)	Shade/rain covered structure in Manufacturing yard
		Locking portable media cart	Hot water for Manufacturing Lab
			Update Drafting Lab computers
			Undersized Drafting Lab--move or expand

Technology Department:
New computers/laptops/tablets
Class sets of headphones with microphones
New computer mice (USB capable)
Digital camcorders
Document cameras
Ebeam
Subscriptions to NetOps Vision, Turnitin.com (plagiarism software), funds for subscriptions to databases for our students, Overdrive
Scanners, Web Cams, Video Conferencing equipment
Remove mold in C-5 and other C buildings
D-1 (Culinary, Nutrition Science and occasionally a LM or TT course)--Major Modernization
Ceiling tiles falling down, physical hazard to food preparation
Lighting installed over ventilation ducts. Efficient cleaning difficult since lights must be taken completely down to clean out fans
Electrical updated needed. Non GFI plugs near food prep areas and often tripped
Triple sink installed with no air-gap, leak frequently and tiles under are molding
Plumbing frequently leaks

Tiles under large refrigerators are breaking and becoming loose
Countertops ideally should be stainless steel or more durable surface like laminate
Walls need to be non-porous for food preparation, paint flakes and comes off when scrubbed
Floor is cracked and holes in floor from old electrical plugs can be hazardous, occasionally a chair leg breaks through & causes student chair to tip
Update facility to meet industry standards for student training per advisory and WASC committees
Stoves need updated to industry level, hood and ansel system
Technology for training with front of house inadequate
Washer and dryer (we currently do 4 loads per day) is in the middle of the academic/seating area. Concurrent use is often loud in classroom
Refrigeration is on the other side of the classroom from the kitchen area. Currently no where to place large refrigerators or under counter refrigeration
There are holes that are open to interior walls in the back of the cabinets where the plumbing has been repaired, but the wall left open
Cords for technology are "octopus like" to connect LCD, teacher workstation, Ethernet cables, etc...
Wireless capability for use in lab stations needs consideration
Inadequate way to receive products, no access easy during daytime for loading supplies and receiving
C-4 (core HECT, LM and TT, Human Dev)
Ceiling tiles are very stained from leaks
Room occasionally leaks
Paint is peeling away
Section of upper wall is disintegrating from the water damage
Rooms smell like a combination of rat urine and mold when it rains
Back storage room houses supplies for about a dozen teachers of CPA and HECT depts.
Countertops may contain asbestos
Tiles coming up and unknown substances under some tile areas
C-7 (Fashion, HERO, CWK)
Need for storage of fashion design supplies/sewing machines, pressing, student projects
Rooms need new ceiling tiles/leaks
Rooms need old electrical panels removed and new electrical system for meeting curriculum standards
No exterior windows
Hall for egress in not professional (was old science storage area)
Faucets leak and not functional
"Octopus-like) cords a danger by teacher work station and when students use machines
Attic access is a pull down ladder in the back of the classroom that when used is distracting and interferes with student learning
Countertops in hall mall contain asbestos
Paint is peeling away
Noise level unacceptable for instruction since you can hear all other classrooms linked to the inner classroom of C-7.
PTSA Recommendations
Air conditioning in both gyms
Enclosed common area developed between both gyms



Student Recommendations	
At least on All Terrain field for soccer, field hockey, football--students trip on holes	Modernize boy's and girl's bathrooms
Sand pit needs (clean) new sand	Swim facility
Awning over the bleachers--sun factor and rain	Heating /cooling A & B buildings
Football field bathroom needs paper towels	B, C, & D building modernization
Renovation of most all bathrooms, especially in C bldg. (hand sanitizers, privacy partitions between urinals, hot water, hand dryers, tampon/kotex pad dispensers, full length mirrors, better lighting, auto flushing toilets, lighter paint, electric seat covers)	Showers/locker room upgrade
Women's staff bathroom next to library--hand dryer on the right doesn't work right	Traffic flow/turn lanes of East Avenue--improve it
Hire a part-time gardener for campus beautification	A/C in large and small gym
A large fountain or two around campus	Improve lighting & ventilation in current classrooms (more windows?)
Valhalla needs to be bigger with glass	P building modernization
Chocolate mike machine	Create softball field
Sprinkler system inside campus that is automatic and doesn't water the cement instead of the plants	Ventilation for locker rooms
More larger evergreen and flowering plants between D&B bldgs.	Improve fields (get rid of rocks, holes, new grass?)
New and more working lockers with PV colors inside gym and around campus	Covering or shade area near track & field
Put evergreen trees/no fruit producing cherries. Trees with pretty blossoms in place of trees cracking cement in quad	Tennis wall
Fiberglass picnic tables in the grass areas next to both sides of the library and by D/C buildings, more picnic tables	Class set of bikes/storage for bike "the mile" instead of run it (CHS)
More garbage cans around campus--especially in parking lot	iPads for all students
Replace the grey tiles with stucco or something more permanent	D-5 needs tables and many chairs replaced. Cushioned chairs instead of plastic ones would be better on the students' back
Overhang from parking lot to main campus, form new building/portables to main campus & between S&P, S&O, O&E/P & O & B	Automated doors--for handicapped students or people with hands full
Swimming pool on out campus with landscaping	Desks with flat cages under desks for books
Student lounge with coffee/hot chocolate/water for sale/ computers-sofas, massage chairs for a cost, hand sanitizer, bathrooms with more than 4 stalls	Air conditioning/heaters that work, are quiet and can be regulated by the teacher
Warming centers for students at lunch time, before and after school	D-5 has an air compressor outside that is so loud that students in classroom can't hear teacher when it goes off
Metal railings around campus not very pretty and cold feeling	There is a hole in the red door in D-5 and it blows in cold air
Have more cameras, especially to catch people tagging murals	We need a full-time tech support person on campus
A Viking statue	We need new/faster computers in classrooms, library, updated laptops and another computer lab..ours is always full
Repaint line in parking lot--make them diagonal	Teachers all need iPads
Replace cement parking spot barriers in parking lot	Lights in D building won't turn on unless all of them are on and randomly go out
Repaint SENIORS	Ceiling D-5 needs to be lowered and new tiles--horrible acoustics
Repaint the gym--paint is flaking off	Large projector screen needed
Not enough food for 2nd lunch students (maybe another food cart)	White boards needed on both sides of room D-5
Plants in the front by the marquee, parking lot, between the gyms, in the new brick planter in front of office	Sink needs to be replaced...it doesn't drain
More water fountains and the water pressure needs to be increased on all of them	The smell from the cooking class is overwhelming
Elmo/3-D Document Camera Projectors in each room	Replace carpeting
Smart boards in each room	More natural light (skylights)
New cafeteria	A system to replace the LCD projector bulbs when they blow out (so they don't come out of the already minimal budgets teachers have)
New culinary kitchen	More exits for parking lot
Bleachers	A place for parents to drop off and pick up students without buses
Turf (soccer, baseball & football)	Major bottlenecking of cars before school and after school
Refurbish gym floor	Air filters in locker rooms and mat room
Fix drainage issues (goodbye Lake PV)	Large weight room to spread out equipment (safer)

Academy For Change (AFC) & Center for Alternative Learning (CAL)

M.S. Credit Recovery

(Facilitator: Marty)

- ± 70 Students
- Expulsion program

Fairview Continuation High School

(Facilitator: Marty)

- 270 Students
- Middle School and High School
- Fairview is an Elementary School housing high school students
 - Upsize it
 - Elementary level drinking fountains, sinks, etc. since this was an elementary school
- All structures are over 25 years old
 - Serious structural issues
- Restrooms need drains so they can be cleaned
 - Must be durable!
- This school needs Science Labs
- Windows with adequate lighting and ventilation
- Drapery is falling apart
- Could use a classroom or two.
 - They are turning away students that belong at this school
- Culinary program would be a great program here
- Need another Resource Room
- Noise from MPR is disruptive in office

Campus Wide

- Fencing is elementary school size
- Asbestos removal needed
- Technology upgrade
- Security Cameras
 - This site has a high degree of vandalism and homeless people
- Fencing improvements
- Site lighting at night
- Nurse area needs more space for high school students injuries and private counseling
-

Oakdale Independent Study

(Facilitator: Marty)

- 130 Students
- Class setting, but only there for an hour or two

- Could use another classroom
- What does this site need?
 - They could use a Gym
 - Rebuild play courts
 - They could use a track
 - Goal posts for soccer
 - These students cannot sit still – Kinesthetic learners
 - PE Room is in serious need of repairs
 - Playground for children of students – This program has a need to grow
 - Building Families program
 - Library is needed

AFC - 270 students
 & 2000 sq ft
 of
FAIRVIEW - 220 students
 1000 sq ft

Fairview is an Elm School housing His Students - 1/2 way in - 1/2 way out. Because the school is on a bus route.

All structures are over 25 years old

- Serious Structural Issues
- Most classrooms need desks so they can be changed. Must be durable!
- The school needs a Science Lab
- Windows with adequate Lighting & Ventilation
- Playground is falling apart.
- Could Use a Classroom for Arts, Music, or Theater
- Many students are being left behind.
- Coding Program would be a great program here.
- Need additional Storage Room
- Need more MS in classrooms in office

Outdated independent Study - 190 Students

- Class setting but only those for an hour or two.
- Could use another Classroom.

What does this site need?

- They could use a Gym.
- Rebuild playgrounds. They could use a track.
- Goal posts for soccer.
- These students can't sit still - Kinesthetic learners
- PE Room is serious need of repairs.
- Playground for children of students, this program has need to grow.
- Building Families program
- Library is needed

AFC School

simple
 Expansion program.

Campus wide

- Feeding in Elm school area.
- Ambassadors needed.
- Technology upgrade
- Security cameras - This site has a high degree of vandalism & stolen property.
- Funding improvements
- Site Lighting at night.
- Noise area needs more space for B.S. Students and private counseling.

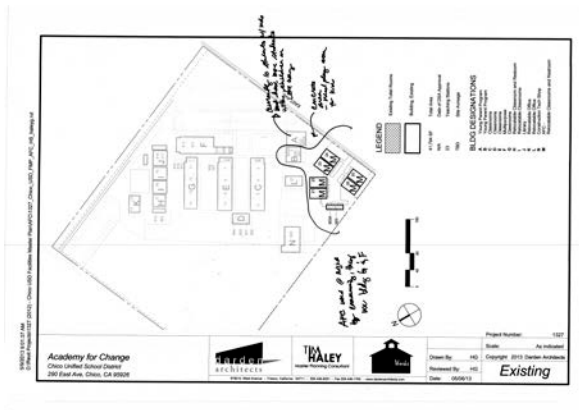

MEASURE E SCHOOL SITE SURVEY

Conducted prior to community input meeting and provided to design team

Fair View Continuation High School, AFC, CAL:

Staff, Student Services Team, Butte County Behavioral Health Members, and Student Leadership Recommendations			
Health and Safety			
Double pane windows		Asbestos removal	Security Cameras around the school
Locks for inside of doors for lockdown procedures		Tree roots sticking out of the ground pushing up sidewalks	More outside lights
Play and PE fields need to be graded		Separate area for toxic art materials and masks	Expand on nursing services and resources
Heating/Air		Structural integrity of all buildings	Create a car-free exercise yard
Covered area for PE and lunch		More outlets per room	Par-course with 1/4 mile oval track
Bathrooms/dual-pane windows		Ability to control thermostats	Put alarm system in SRO office
Curtains		Fence around campus-to create single point of entry with locks	Clinic-well baby WIC on campus
Recycle bins and all-weather cement trash receptacles		Floor drain in the bathrooms	
Maintenance			
Renovate bathrooms		Resurface blacktop	Flooring tile replacement
Stainless steel sinks and toilets		Doors	Repair wooden ramps
Dark tile or no wax floors for all rooms		New curtains	Beautification throughout school-plants, flowers, etc.
Drinking fountains working		Roofing repairs/renovations	
		Rain gutters	
Technical Improvements (computerization, etc.)			
Update computers for teachers		Smart boards/white boards	LED projectors on ceiling
Higher speed internet		Photoshop or Adobe Illustrator program for computers	Flat screen TV in MPR
New computers for staff and students		A computer with proper printer for class	
Computer work stations in room 9			
Modernization			
Solar panels		Windows in the SST office	Skylights
Floor drains in the outside bathrooms		Dual pane windows	Kiln for ceramic firing
Fence around the back of art room		Outside drinking fountain	Labs for Science and Art
Parking		Full-size basketball court	Auto Shop
Efficient lighting		A new young parent program and FVHS van	Paint interior and exterior
Fitness center		Update structure from elementary school to high school	
Energy Efficiency			
Update heating systems		Overhead lights	Weather strip windows and doors
Dual pane windows		Window/doorways need to be replaced	Water filters
Skylights			
Solar panels		Install solar panels where you can	
Solar tubes			

<i>New Construction</i>			
Culinary Arts Kitchen		Media Center	Gated section for Art Supplies behind the classroom
Career Tech/ Silk-Screening Room		Resource room for FVHS alone	Indoor gym
Library		Real Science room	Bathroom with shower for health room
Separate rooms for Oakdale		Gym/spinning bicycles	Convert the boiler room into the central custodial room
Covered Lunch area		Update main office	Create a storage building
Fitness center		Make MPR separate from office	Replace portables
Gymnasium or covered PE area		Building for Oakdale	

Inspire School of Arts and Science

(Facilitator: Ellen & Haley)

- Maximum capacity for 480 Students/Currently 400 Students enrolled
- Program exists mainly in Portables with one room in adjacent building (see colored plan)
- The Portables are in bad shape:
 - Students get sick
 - The portables are all old
 - There are some portables being replaced this summer, but they are not "new" they are refurbished – 25 years old
 - They currently have leaking problems; the brand new double-wide leaks, as well as others – most leak
 - Bad tile (VCT), other flooring, finishes in general
 - Whiteboards don't erase
 - HVAC doesn't work -- it's loud, old
 - Survival, Safety & Upgrade
 - These are basic survival needs – maintenance overshadows facility/program improvements
- Arts and Science Program needs space
 - Facilities Limit Us!
- New Wet Lab is a step in the right direction
- PVHS Center for the arts is a great facility, but presents problems logistically for their students to use the PVHS facility
- Would love a black box theater for their program needs & desires
- A New Campus would be desirable
 - Existing small site and proximity has actually contributed to the sense of camaraderie and student-teacher relationship – We don't want to lose that!
 - Being at a separate site would enable the program to be more successful
 - Putting more money into the existing site is problematic because it's just a band-aid and how would it affect the future of Chico HS
- Original list covers Health & Safety (look to list in pamphlet pulled from list from District)
- Storage needs are massive, they need space to store:
 - Textbooks
 - Science instruments
 - Performing Arts related items
- CRT (Chico Regional Theater) is where they currently practice/perform
 - Relationship currently (student's parent) is a good fit but what happens in the future?
- Students have built sets in old Band Room at Bidwell because they have no space at Inspire
- Huge storage/trucking bills – Paid for moving trucks to move items back and forth and storage units to store items
 - Time is spent problem-solving space needs rather than focusing on the academic program
 - Went through process with previous architect to design a new site that accommodated their needs and desires

- Had spaces for programs and student gathering
- Food Service:
 - Lines too long
 - Currently at Chico HS
 - With ongoing construction of Lincoln Hall, it's impacting the demand and service for students
 - Many students go downtown to eat and then return to campus
 - Chico HS students are kind of mean to Inspire students
- No physical space to fix IT needs
 - Projectors/AV/Computers need space to work on this equipment
- All classrooms in-class use except for 1 building
- No breathing space for Teachers
 - No prep space
 - New Administration Building finally has staff lounge
- It's a well-utilized site of buildings
 - Focus on Performing Arts and Science
 - Inspire is the only NorCal "Project Lead the Way" for Engineering
 - Getting new room with new portables is just a temporary fix
 - Doing Science experiments in a portable is difficult - chemicals used cause more wear and tear on surfaces
- Students are Talented!
 - They could do so much more with a space that is conducive to the type of programs at Inspire
 - Program looks to balance students exposure to both Arts & Sciences
 - Difficult spatially because they need spaces for both programs and these types of programs require large spaces (ie: science labs, dance studios, stages, shops, etc.)
 - Don't want to see students feel defeated because they don't have space to excel
 - Outside open space is lacking as there is currently no space for students to gather
 - No outdoor covered space
 - Rainy season creates "Lake Inspire" - this is really what the nickname is!
- On existing site: Open for solar if shade structures are done
- Inspire needs its own identity – School identity helps students have their own identity!
 - Even if Inspire stays at existing site if it was just painted differently that could help
 - Currently students are painting murals on teacher's doors, which helps to create some identity/pride – Teachers are their clients
 - Students take ownership of their space which creates pride in their school and themselves
- Safety
 - No fencing currently with barriers
 - Locks on doors are a problem – Teachers can currently only lock door from outside
 - Look at existing list – It's very complete (refer to list from District)
- Inspire is a School of Choice for many students/parents
 - What makes you decide to go there?
 - It's certainly NOT the facilities!!!
 - It's the program – Staff is engaged with students & responsive to their needs

- Teachers – their credentials and talents speak volumes
- The people, Have a great Principal
- Cap on enrollment size also creates some demand for program
- Students get along well: They accept each other’s identities & differences
- Students get what they can’t get (or afford) at traditional high school
 - Dance, Performing, etc.
- They feel more welcomed at this school, surrounded by other students with shared interests
- Students “fit in” by doing their own thing, rather than at traditional high school where students try to fit in by being part of the “norm”
- The Inspire student mentality is closer to the university student mentality
- No competition of students for identity & cliques & being cool
- What would the interim housing needs be if there is space to build a permanent building on existing site?
- Would like to see this Measure E money go towards planning for the future of this program & site
- Real concern about long-term work that would be done at Inspire and how it affects Chico High School’s future related to space and planning
- Current connections with Chico State need to be considered as they play a big role and Inspire would want to keep that connection
- Where are we going to be long-term?
 - What does it look like?
 - Actually do love being on Chico High School site with relationship with Chico State and close to downtown
 - Chico State - Inspire students goes back and forth to their facilities all the time for their programs & instruction & facilities
- Environment affects behavior!!
 - Inspire Identity is more of an urban school
 - That’s where new technology and inclusion happens, in the urban environment, would like to keep part of that urban identity

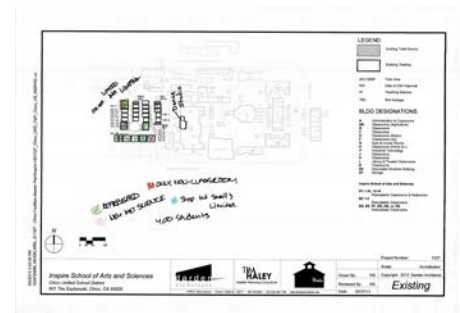

MEASURE E SCHOOL SITE SURVEY

Conducted prior to community input meeting and provided to design team

Inspire School of Arts and Science:

Staff Recommendations	Student Government	Parent and Inspire Foundation Board Input
Hot water in the bathrooms	Air conditioning/heater repair	Deferred Maintenance
HVACs need work	Get rid of Inspire Lake (get a drain)	Provide proper drainage
New paint in classrooms	Hot water needed	Repair old ceiling tiles and dry rot
New floors in classrooms	Toilet paper protectors	Repair ramps into the portables
Security Cameras	First row of classrooms should be moved to face Inspire	Refurbish and paint for the older portables
Technology- iPads?	Air dryers for the bathrooms	Provide hot water to the campus
New desks	New desks	Modernization
Leaky roofs	Picnic tables and benches	Structures to protect students from the elements
Dripping awnings over ramps	Food truck for Inspire	Adequate lighting at night
Slick/slippery ramps (repair or replace)	Fix the roofs	Security cameras
"Lake Inspire"	Chipping paint needs to be fixed	Fencing around the perimeter
Mud on the south side of campus	Pope's room is leaking (PC 16)	Landscaping
Practice & storage areas for music room	Henderson's room is leaking (PC 9)	Solar
Landscaping	Student store space needed	Awnings over windows
Concrete around buildings	Floors need to be fixed	Technology
Smart Boards in classrooms	Tile replacement	Move to electronic textbooks on iPad or tablet
Update video projectors in classrooms as needed	Marquee for Inspire	
Mac Computers for audio	Filtered water	
Proper windows blinds for Code Red	Hoses	
Materials to help organize & tame unruly computer cords	Better tech support	
New windows	Trees	
New ceiling tiles	More bike racks	
Covered area for kids to congregate	Concrete walkways	
More bike racks that are not in standing water		
Fix HVAC in wrestling/matt room & weight room		
Cover or insulated fans in wrestling/matt/weight room		
Adequate lighting along path from student parking to gym		
Outdoor seating for students at lunch time		

Chico High School

(Facilitator: Mike Cannon)

- Need for a full Stadium onsite
 - New Stadium could be a revenue source for the Athletics Department
 - New Stadium could also increase enrollment draw and create equity
 - Install All-Weather Track to host meets
 - Install adequate Lights & Bleachers (See “Vision” Booklet
- There is a need for bathrooms on the athletic fields and drinking fountains
- Install Outdoor Teaching Areas/IMP, Turf
- Install Fencing/Security (CSUC Access)
- Install & Monitor a Comprehensive Camera System
- Build New Music Facilities for Expanding Program (both Inside/Outside: Equity w. PV)
- Build New Tennis Courts
- Install New HVAC in Wrestling/Weight Area (Repurposing)
- Install New HVAC System in Main Gym Building
- Strengthen Tech Support for Tech Systems
- Build Overhead Pedestrian Walkway across Esplanade Street
- Reconfigure/Resize Boy’s Locker Room for Enrollment & Use/Security; replace Lockers
- Install Additional Solar Panels on Site
- Add Parent Parking Adjacent to Office
 - Parent Parking now Off-Site
 - Drop Off Areas Dangerous (ACL)
- Install a Public Traffic Light at Front of School (Esplanade & W. Sacramento); Look at Ft. Bragg Traffic System as possible Model
- Install Teaching Technology (Smart Boards, etc.) in all classrooms
- Give Other CHS Sports – Access to R.R.’s
- Need Equality in High School Sports Facilities
- Classroom Security; Code Red Issues (?)
- Upgrade Technology Access/Upgrades
- Need Weight Room Improvements
 - HVAC and Other Improvements
 - Add Water Fountains & Mirrors
- Let’s Make it a High School (Finish)
- Install Lockers for Students (Books, eBooks)
- Campus is Clean & Bright – Great Maintenance
- Install New Bicycle Parking Area

(Facilitator: Tim Haley)

- Stadium, Football “On Site”
 - All-Weather Track to host meets
 - Lights
 - Bleachers
 - See “Vision” Booklet
- Other Sports – Access to R.R.’s

- Equality in High School Sports
- Classroom Security
 - Code Red Issues
- Technology Access/Upgrades
- Transportation
- Weight Room Improvements
 - HVAC and Other Improvements
 - Water, Mirrors
- Current Locker Room Issues
- Let's Make it a High School (Finish)
- Lockers for Students (Books, eBooks)
- Clean Bright – Great Maintenance
- Bicycle Parking Area

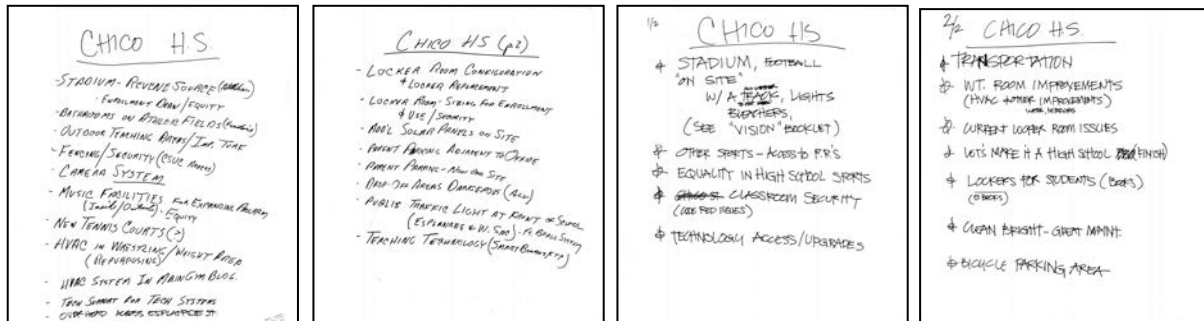

MEASURE E SCHOOL SITE SURVEY

Conducted prior to community input meeting and provided to design team

Chico High School:

Staff Recommendations	Student Input
General Items	General Items
Lighting for walkway between Gym and student parking	Lighting for walkway between Gym and student parking
Lighting for Interior of campus	Improved computers in Library
Security Cameras on campus	Security Cameras on campus
HVAC in Library	Poor drainage in parking lot
Roof Repair (Gym & offices, A-Bldg., F-wing, Library, H-wing)	Roof Repair (Gym & offices, A-Bldg., F-wing, Library, H-wing)
Painting exterior of school	Painting exterior of school
D-wing hallway (music) needs interior painting	Poor drainage on blacktop path between Gym and parking lot
Misc. seat repair in Williams Theater	Misc. seat repair in Williams Theater and poor lighting
Blind entrance/exit to staff parking lot on W. Sac is dangerous	Blind entrance/exit to staff parking lot on W. Sac is dangerous
Drinking fountains around campus	Drinking fountains around campus
Replacement of old locks (need to lock from inside during Code Red)	New hand dryers in B & C wings
Visitor check-in system with immediate background check	Football stands
Athletic Fields	
Stands for seating next to track/football field (1500-2000 people)	
Attached press box	
Restrooms that serve 1500-2000 people	
Resurfaced track	
Fencing to secure field	
A-Building	A-Building
Modernization of A-Building	Modernization of A-Building
Women staff restroom toilets do not work properly	Drains on roof of A-Building
Doors throughout the A-Wing do not close properly	Leaky rook (see above)
Drains on roof of A-Building (currently run off like a waterfall)	
Faculty restrooms in A-Building (remodel)	
Leaky rook (see above)	
F-wing (Art)	F-wing (Art)
Cover, enclose, and secure storage area	Add covers to the security lights around the building
Repair leaking roof in at least six locations	Repair leaking roof in at least six locations
Sink drains-drain lines & traps need to be replaced	Sink drains-drain lines & traps need to be replaced
Add covers to the security lights around the building	
F-4 and F-5 need more electrical outlets, power poles and data lines	

Staff Recommendations	Student Input
F-3 needs more electrical outlets for potter's wheels	
F-1 needs window above door replaced	
Extend roof line or add cover above our doors to protect from rain	
<i>P.E. Facilities</i>	<i>P.E. Facilities</i>
Bell & Speakers in P.E. fields	Bell & Speakers in P.E. fields
Code Red Lighting (flashing lights) in gym	Code Red Lighting (flashing lights) in gym
Heating units in the gym	Heating units in the gym
Gym backboards in need of repair	Re-surface track
Boy's and Girl's locker room lockers broken	Boy's and Girl's locker room lockers broken
Fencing separating the parking lot and athletic fields for safety	
Fix HVAC in wrestling/matt room and weight room	
Cover or insulate fans in wrestling/matt room and weight room	
<i>S-Wing (Science)</i>	<i>S-Wing (Science)</i>
Poor drainage around S-wing during storms	Poor drainage around S-wing during storms
A/C in Science Equipment Storage area (backroom)	Replacement of old locks (need to lock from inside during Code Red)
Replacement of old locks (need to lock from inside during Code Red)	



APPENDIX

School Site input received after individual school site community meetings:

GENERAL MEASURE E INPUT

- I would like to give some input on how Measure E funds may be allocated.
 - First, I would like to see Inspire High School moved to an independent campus. Inspire has proven its worth in the outstanding quality of education and innovative programming. It is an asset to the community and to the students who attend there. Initially the plan was for Inspire to have its own campus, but that seems to have fallen by the wayside. For the benefit of students, staff, and parents (at both Chico High and Inspire) down the road, I would like to see a workable plan for creating an independent campus for Inspire. It doesn't have to be fancy, just separate!
 - Second, I would recommend allocating some funds to necessary upgrades at the ROP culinary arts program. This is a first rate program and is especially beneficial to students who would like an alternative or supplement to college. It gives these students necessary and marketable skills that they can use to support themselves throughout life. Please consider allocating some funds to necessary upgrades there.

HOOKER OAK ELEMENTARY SCHOOL

- GENERAL CONDITION COMMENTS:
 - As a seven year parent of Hooker Oak, I have a couple of ideas that I think would be nice additions to the school.
 - ~ (Hooker Oak Mom)
 - First of all it would be really nice to have actual doors on the adults restroom stalls. It has always seemed odd to me that there are curtains there.
 - Second I would really like to see shorter basketball hoops for the 1-3 grade children. I have seen them at Sierra View and thought they were a really great idea.
- GENERAL CONDITION COMMENTS
 - Concerns about some of the conditions at my daughter's school, in the hopes that some of the Measure E funds will be used to make things better.
 - ~ (Hooker Oak Dad)
 - Kitchen floor needs total resurfacing/rebuilding
 - Kitchen ovens don't work well. Are old and outdated for school needs.
 - Wing 3 restrooms are dark & dank.
 - Ongoing multiple leaking ceiling areas. Roof replacement needed.
 - Electrical circuitry is old thus does not support the technology infusion that has occurred in the last 10 years.
 - Circuits are blown almost daily.
 - Window frames to garden and nature areas have decaying wood that is increasing through the years.

- Hallways and office rooms are freezing. (Office is cold because we keep the door open to see visitors. Thus, the cold (lack of heat) from the hallway comes into the office.)
- Wing 1 and 2 boy's restroom tiles were never sealed properly thus urine soaked into caulking and smell never goes away. Gets worse in warm weather.
- Only one outside water fountain for students.
- Concrete foundation and walls have separated which in rains cause water to enter building. Ants also use this entry into the building.
- Carpet in kindergarten room 18 is buckled, grungy, torn. Needs replacing.
- Main office is outdated, cramped, little heat.
- Safety access into building needs modernizing per safety needs of the times.
- All classrooms need LCD projectors mounted from ceiling.
- Laptops for all teachers needed
- Replace bathroom floors
- Repair bathroom ceilings.
- A/C needed in kitchen (presently just has an old swamp cooler.
- Replace dishwasher.
- Seal and upgrade basement.
- New classroom wire and circuit breakers.

PLEASANT VALLEY HIGH SCHOOL

● CULINARY ARTS PROGRAM COMMENT

- I've worked with the culinary program for many years and know the value of well-trained students. I support the use of Measure E Funds for the CTE pathway Food Service and Hospitality. As this industry sector continues to grow, the Pleasant Valley High school Culinary program needs an updated facility that meets industry requirements. This will allow students to be well trained and opportunities for careers.
~ (Educator)

● CULINARY ARTS PROGRAM COMMENT

- As a student and participant of PVHS's culinary program, I see many ways in which Measure E funding can greatly benefit the culinary CTE program. Our facility is old and out-dated, and would greatly prosper from new improvements and appliances. Our culinary program would greatly benefit from new industrial stoves, ovens, and repairs for our triple sink. Training students for culinary careers with industrial equipment is of upmost importance so students are entering the work place with experience using and cooking with specialized equipment and appliances. I am a great supporter of the culinary program and its role in aiding students in the food service and hospitality career pathways and I would love to see this program receive Measure E funding.
~ (Culinary Program student)

● CULINARY ARTS PROGRAM COMMENT

- Hi I would like to show my open support to Measure E. I have worked with the culinary program for 3 years now and know the value of well-trained students. A hot line training section and update make a lot of sense; training students for attainable and careers in this job sector open many doors for them in the future. This job sector continues to grow and provide opportunities. The PVHS Culinary program needs an update to facility

to continue serving students well and training them towards careers. I was a culinary student and would have benefited in skill development and training by having adequate commercial equipment to train on during my time in class. Not only commercial equipment but we could really use and update to the refrigeration and sculler, our facilities were built in 1964 and have hardly been updated for the next century. I support the use of Measure E funds for the CTE pathway area of Food service and hospitality training....thank you for your time
~ (Concerned Citizen)

- **CULINARY ARTS PROGRAM COMMENT**

- **Staff and Student Recommendations:**

- We've worked with the culinary program for a year and know the value of well-trained students. I support the use of measure E funds for the CTE pathway area of Food service and hospitality training.
- With the culinary program I was trained with how to prepare multiple varieties of nutritious meals as well as what equipment is used for certain situations. However, we lack certain equipment that could further train us for today's work environment.
- We need more money for new equipment.
- We've worked in the culinary program for 1 year and know the value of well-trained students. I support the use of measure e funds for the cte pathway area of food service and hospitality training.
- Being trained on professional equipment will help me prepare for working in an industrial kitchen at a five star hotel or big kitchen. We currently don't have all the correct equipment to successfully learn on.
- I think PV needs some new culinary things are kitchens are old the more we learn here the more it will prepare us to be successful. We're missing a lot of things and it limits us on what we can learn.
- We've worked with the culinary program for 2 years and know the value of well-trained students. I support the use of measure E funds for the CTE pathway area of Food service and hospitality training.

CHICO JUNIOR HIGH SCHOOL

- **SHAPIRO POOL**

- Operated by the Chico Area Recreation District, it needs help and repair/replacement and has ADA issues
- Shapiro Pool, built in the late 50's is on its last leg. CUSD utilizes Shapiro for P.E. Classes for Chico Jr. High, as well as Chico High School Swim Team. The pool is also utilized for water safety to help kids to learn to swim. I am respectfully requesting that you place Shapiro Pool on your list of discussion items to be considered for Measure E allocations. I understand the process has just begun and if included on the list we would be available to attend any meeting concerning the pool.
(~ Chico Area Recreation and Park District)

BIDWELL JUNIOR HIGH SCHOOL

- **GENERAL CONDITION COMMENTS:**

- I'm writing to you because I can't make it to the Measure E meeting on May 8th, but I do have an idea for an improvement.
 - I'm sure you are aware of the real problem area under the tree outside 401 and 402. The cinder blocks are loose, creating a tripping/falling hazard. And worse, the amount of dirt that swirls into the classrooms and piles into the walkways is awful. All that dust is a health hazard for students and adults who suffer from allergies, asthma or other respiratory conditions. Based on health concerns alone, this problem needs to take top priority.
 - Second to the health and safety of our students and staff is the sheer cleanliness of the rooms affected. Dirty rooms adversely affect morale..."I work in a filthy place." "I learn in a filthy place." How people feel about their surroundings affects their performance.
 - Third, this problem must take an inordinate amount of work-hours on behalf of the custodial staff in their attempt to keep the 400 wing clean.
 - Fourth, all that dirt and dust being kicked up in the classrooms cannot be good for the HVAC system and filters. If we invest in money in a new HVAC system, we have to consider the damage all this dirt, leaves and dust will cause the system.
- Remember how bad the front of Chico High used to be before they put up the black fencing along the sidewalk? I think something like that could solve this problem and make the area beautiful to boot! The fence wouldn't have to travel far to protect the area. And some kind of plan could be made for the scorched earth zone...replant grass, cover with some kind of appropriate material, cement it over. Even a raised planter with areas to sit around it could be part of the solution. The contractor would have to make sure the fence is high enough so that it's not an open invitation for junior high students to challenge their jumping skills to get over it, but instead forces foot traffic around it. :) I know that area must be a constant headache for you, your staff and Bidwell's students. I feel strongly that this is an important issue that needs a permanent solution, and could be solved with relatively little money (compared to other projects). It would really get us a lot of "bang for our buck."

MEASURE E SITE SURVEY

Transportation

Staff Recommendations
We need newer Special Ed buses. Our fleet is worn out & we are getting more & more special needs students, without the buses to transport them.
I would like to suggest that a portion of the Measure E money be used to purchase some new or slightly used Type 2 buses. Type 2 buses are used for our special needs students. We have students that are very temperature sensitive. Our current fleet consists of several older buses that are between 22-28 years old and the air conditioning and heating systems work poorly. This is a serious health and safety issue.
We need new or used Type II school buses that do not have over 500,000 miles on them and some do not have air conditioning that works very well! To much money is spent on "band aiding" the old buses. We have too many kids that are heat sensitive, let alone the driver.

MEASURE E SITE SURVEY

DISTRICT OFFICE

Staff Recommendations
Software and hardware updates
More parking
Solar panels here?
Upgrade hot water heater; water is very slow to warm up
Dual pane windows or coverings
Insulation blown into walls
Linoleum/flooring instead of carpet in hallway
Need more meeting space--perhaps an extra portable?
Working lights for front, back and side parking lots
HVAC system does not work equitably around the building (stop outside air from coming in)
Painting--especially peeling wooden areas
Power wash
Interior and exterior paint
Electronic sign on corner announcing events
Updated board behind Charlotte; better directions needed
CUSD sign/logo painted on building
Camera in front reception area
Alert system for remote areas (i.e., LCR and Psych area) to alert main building of emergencies
A new plaque under the bell
Get rid of paper rainbow open sign--more professional signage
Don't like the way the data center is set up. Need to find ways for staff to open up.
Carpet in the floor pathways for cable (data center)
Payroll stays on if power goes out, can power be extended to the rest of DO? Need bigger generator.
Need bigger/taller table in copy room
Moisture issues in the basement?
Office doors for all offices (for security issues)
Wiring and plumbing ok???
Need more structure cabling--was last done in 2003 by Chico Electric
Caller ID-Phone system should be voiceover IP more options to distribute voicemails, centralizing phone system
Computer problems--help desk--chat now--where you get live chat
Don't all have the same software on all computers, can't always open items from others
Would like brown bag-bring your lunch- hour and a half trainings
Spanish Language training